



CALL NO. 400

CONTRACT ID. 212961

VARIOUS COUNTIES

FED/STATE PROJECT NUMBER 121GR21M003 - FD04

DESCRIPTION VARIOUS ROUTES DISTRICT 1

WORK TYPE BRIDGE PAINTING & CLEANING

PRIMARY COMPLETION DATE 11/30/2021

LETTING DATE: March 19, 2021

Sealed Bids will be received electronically through the Bid Express bidding service until 10:00 am EASTERN DAYLIGHT TIME, March 19, 2021. Bids will be publicly announced at 10:00 am EASTERN DAYLIGHT TIME.

NO PLANS ASSOCIATED WITH THIS PROJECT.

REQUIRED BID PROPOSAL GUARANTY: Not less than 5% of the total bid.

TABLE OF CONTENTS

PART I	SCOPE OF WORK <ul style="list-style-type: none">• PROJECT(S), COMPLETION DATE(S), & LIQUIDATED DAMAGES• CONTRACT NOTES• STATE CONTRACT NOTES• SPECIAL NOTE(S) APPLICABLE TO PROJECT• ASBESTOS ABATEMENT REPORT• MATERIAL SUMMARY• BRIDGE DRAWINGS
PART II	SPECIFICATIONS AND STANDARD DRAWINGS <ul style="list-style-type: none">• SPECIFICATIONS REFERENCE• SUPPLEMENTAL SPECIFICATION• STANDARD DRAWINGS THAT APPLY
PART III	EMPLOYMENT, WAGE AND RECORD REQUIREMENTS <ul style="list-style-type: none">• LABOR AND WAGE REQUIREMENTS• EXECUTIVE BRANCH CODE OF ETHICS• KENTUCKY EQUAL EMPLOYMENT OPPORTUNITY ACT OF 1978 LOCALITY / STATE• PROJECT WAGE RATES / STATE FUNDED
PART IV	INSURANCE
PART V	BID ITEMS

PART I
SCOPE OF WORK

ADMINISTRATIVE DISTRICT - 01

CONTRACT ID - 212961

121GR21M003 - FD04

COUNTY - CARLISLE

PCN - MB02013712101

FD04 020 1371 B00040N 06.25

MILBURN ROAD (KY 1371) BRIDGE 020B00040N OVER UNNAMED STREAM AT MP 06.25BRIDGE DECK RESTORATION & WATERPROOFING SYP NO. 01-10169.00.

GEOGRAPHIC COORDINATES LATITUDE 36:51:35.00 LONGITUDE 88:55:37.00

COUNTY - FULTON

PCN - MB03800512101

FD04 038 0051 B00012N 04.86

NOLAN AVENUE (US 51) BRIDGE 038B00012N OVER PURCHASE PARKWAY (JP 9003) AT MP 04.86BRIDGE DECK RESTORATION & WATERPROOFING SYP NO. 01-10169.00.

GEOGRAPHIC COORDINATES LATITUDE 36:31:04.00 LONGITUDE 88:38:11.00

COUNTY - GRAVES

PCN - MB04203392101

FD04 042 0339 B00132N 30.31

FANCY FARM - LOWES ROAD (KY 862) BRIDGE 042B00132N OVER GOOSE CREEK AT MP 30.31BRIDGE DECK RESTORATION & WATERPROOFING SYP NO. 01-10169.00.

GEOGRAPHIC COORDINATES LATITUDE 36:51:08.00 LONGITUDE 88:46:43.00

PCN - MB04208492101

FD04 042 0849 B00084N 10.77

FOLSOMDALE - BOAZ ROAD (KY 849) BRIDGE 042B00084N OVER MAYFIELD CREEK AT MP 10.77BRIDGE DECK RESTORATION & WATERPROOFING SYP NO. 01-10169.00.

GEOGRAPHIC COORDINATES LATITUDE 36:53:07.00 LONGITUDE 88:38:11.00

COUNTY - HICKMAN

PCN - MB05312832101

FD04 053 1283 B00102N 00.07

WATER VALLEY ROAD (KY 1283) BRIDGE 053B00102N OVER PURCHASE PARKWAY (JP 9003) AT MP 00.07BRIDGE DECK RESTORATION & WATERPROOFING SYP NO. 01-10169.00.

GEOGRAPHIC COORDINATES LATITUDE 36:35:19.00 LONGITUDE 88:49:00.00

COUNTY - LYON

PCN - MB07226112101

FD04 072 2611 B00029N 00.10

PLEASANT VALLEY ROAD (KY 2611) BRIDGE 072B00029N OVER I-69 AT MP 00.10BRIDGE DECK RESTORATION & WATERPROOFING SYP NO. 01-10169.00.

GEOGRAPHIC COORDINATES LATITUDE 37:06:30.00 LONGITUDE 88:00:04.00

COUNTY - MCCracken

PCN - MB07313222101

FD04 073 1322 B00081N 03.80

LOVELACEVILLE ROAD (KY 1322) BRIDGE 073B00081N OVER MIDDLE FORK MASSAC CREEK AT MP 03.95BRIDGE DECK RESTORATION & WATERPROOFING SYP NO. 01-10169.00.

GEOGRAPHIC COORDINATES LATITUDE 37:00:37.00 LONGITUDE 88:44:50.00

LOVELACEVILLE ROAD (KY 1322) BRIDGE 073B00080N OVER UNNAMED STREAM AT MP 03.80BRIDGE DECK
RESTORATION & WATERPROOFING SYP NO. 01-10169.00.
GEOGRAPHIC COORDINATES LATITUDE 37:00:40.00 LONGITUDE 88:44:41.00

COMPLETION DATE(S):

COMPLETED BY 11/30/2021	APPLIES TO 038B00012N
COMPLETED BY 11/30/2021	APPLIES TO 042B00084N
COMPLETED BY 11/30/2021	APPLIES TO 042B00132N
COMPLETED BY 11/30/2021	APPLIES TO 053B00080N
COMPLETED BY 11/30/2021	APPLIES TO 053B00102N
COMPLETED BY 11/30/2021	APPLIES TO 072B00029N
COMPLETED BY 11/30/2021	APPLIES TO 073B00081N
COMPLETED BY 11/30/2021	APPLIES TO 020B00040N
COMPLETED BY 11/30/2021	APPLIES TO ENTIRE CONTRACT

CONTRACT NOTES

PROPOSAL ADDENDA

All addenda to this proposal must be applied when calculating bid and certified in the bid packet submitted to the Kentucky Department of Highways. Failure to use the correct and most recent addenda may result in the bid being rejected.

BID SUBMITTAL

Bidder must use the Department's electronic bidding software. The Bidder must download the bid file located on the Bid Express website (www.bidx.com) to prepare a bid packet for submission to the Department. The bidder must submit electronically using Bid Express.

JOINT VENTURE BIDDING

Joint venture bidding is permissible. All companies in the joint venture must be prequalified in one of the work types in the Qualifications for Bidders for the project. The bidders must get a vendor ID for the joint venture from the Division of Construction Procurement and register the joint venture as a bidder on the project. Also, the joint venture must obtain a digital ID from Bid Express to submit a bid. A joint bid bond of 5% may be submitted for both companies or each company may submit a separate bond of 5%.

UNDERGROUND FACILITY DAMAGE PROTECTION

The contractor shall make every effort to protect underground facilities from damage as prescribed in the Underground Facility Damage Protection Act of 1994, Kentucky Revised Statute KRS 367.4901 to 367.4917. It is the contractor's responsibility to determine and take steps necessary to be in compliance with federal and state damage prevention directives. When prescribed in said directives, the contractor shall submit Excavation Locate Requests to the Kentucky Contact Center (KY811) via web ticket entry. The submission of this request does not relieve the contractor from the responsibility of contacting non-member facility owners, whom shall be contacted through their individual Protection Notification Center. Non-compliance with these directives can result in the enforcement of penalties.

REGISTRATION WITH THE SECRETARY OF STATE BY A FOREIGN ENTITY

Pursuant to KRS 176.085(1)(b), an agency, department, office, or political subdivision of the Commonwealth of Kentucky shall not award a state contract to a person that is a foreign entity required by [KRS 14A.9-010](#) to obtain a certificate of authority to transact business in the Commonwealth ("certificate") from the Secretary of State under [KRS 14A.9-030](#) unless the person produces the certificate within fourteen (14) days of the bid or proposal opening. If the foreign entity is not required to obtain a certificate as provided in [KRS 14A.9-010](#), the foreign entity should identify the applicable exception. Foreign entity is defined within [KRS 14A.1-070](#).

For all foreign entities required to obtain a certificate of authority to transact business in the Commonwealth, if a copy of the certificate is not received by the contracting agency within the time frame identified above, the foreign entity's solicitation response shall be deemed non-responsive or the awarded contract shall be cancelled.

Businesses can register with the Secretary of State at <https://secure.kentucky.gov/sos/ftbr/welcome.aspx>.

SPECIAL NOTE FOR PROJECT QUESTIONS DURING ADVERTISEMENT

Questions about projects during the advertisement should be submitted in writing to the Division of Construction Procurement. This may be done by fax (502) 564-7299 or email to kytc.projectquestions@ky.gov. The Department will attempt to answer all submitted questions. The Department reserves the right not to answer if the question is not pertinent or does not aid in clarifying the project intent.

The deadline for posting answers will be 3:00 pm Eastern Daylight Time, the day preceding the Letting. Questions may be submitted until this deadline with the understanding that the later a question is submitted, the less likely an answer will be able to be provided.

The questions and answers will be posted for each Letting under the heading "Questions & Answers" on the Construction Procurement website (www.transportation.ky.gov/contract). The answers provided shall be considered part of this Special Note and, in case of a discrepancy, will govern over all other bidding documents.

HARDWOOD REMOVAL RESTRICTIONS

The US Department of Agriculture has imposed a quarantine in Kentucky and several surrounding states, to prevent the spread of an invasive insect, the emerald ash borer. Hardwood cut in conjunction with the project may not be removed from the state. Chipping or burning on site is the preferred method of disposal.

INSTRUCTIONS FOR EXCESS MATERIAL SITES AND BORROW SITES

Identification of excess material sites and borrow sites shall be the responsibility of the Contractor. The Contractor shall be responsible for compliance with all applicable state and federal laws and may wish to consult with the US Fish and Wildlife Service to seek protection under Section 10 of the Endangered Species Act for these activities.

ACCESS TO RECORDS

The contractor, as defined in KRS 45A.030 (9) agrees that the contracting agency, the Finance and Administration Cabinet, the Auditor of Public Accounts, and the Legislative Research Commission, or their duly authorized representatives, shall have access to any books, documents, papers, records, or other evidence, which are directly pertinent to this contract for the purpose of financial audit or program review. Records and other prequalification information confidentially

disclosed as part of the bid process shall not be deemed as directly pertinent to the contract and shall be exempt from disclosure as provided in KRS 61.878(1)(c). The contractor also recognizes that any books, documents, papers, records, or other evidence, received during a financial audit or program review shall be subject to the Kentucky Open Records Act, KRS 61.870 to 61.884.

In the event of a dispute between the contractor and the contracting agency, Attorney General, or the Auditor of Public Accounts over documents that are eligible for production and review, the Finance and Administration Cabinet shall review the dispute and issue a determination, in accordance with Secretary's Order 11-004.

April 30, 2018

SPECIAL NOTE FOR RECIPROCAL PREFERENCE

RECIPROCAL PREFERENCE TO BE GIVEN BY PUBLIC AGENCIES TO RESIDENT BIDDERS

By reference, KRS 45A.490 to 45A.494 are incorporated herein and in compliance regarding the bidders residency. Bidders who want to claim resident bidder status should complete the Affidavit for Claiming Resident Bidder Status along with their bid in the electronic bidding software. Submittal of the Affidavit should be done along the bid in Bid Express.

April 30, 2018

**3SPECIAL NOTES
DISTRICT NO. 1
BRIDGE DECK RESTORATION AND WATERPROOFING
VARIOUS COUNTIES
CID 212961 ~ 121GR21M003**

FD04 020 1371 B00040N 06.25

Carlisle County ~ KY 1371 (Milburn Road) over Unnamed Stream

Geographic Coordinates

Latitude 36° 51' 35.00'' (36.8598)

Longitude -88° 55' 37.00'' (-88.9268)

Description

3~30' RCDG Spans, Drawing No. 14017

FD04 038 0051 B00012N 04.86

Fulton County ~ US 51 (Nolan Avenue) over JP 9003 (Purchase Parkway)

Geographic Coordinates

Latitude 36° 31' 04.00'' (36.5177)

Longitude -88° 53' 25.00'' (-88.8901)

Description

2~21' RCDG Spans, Drawing No. 16696

FD04 042 0339 B00132N 30.31

Graves County ~ KY 862 (Fancy Farm-Lowes Road) over Goose Creek

Geographic Coordinates

Latitude 36° 51' 08.00'' (36.8523)

Longitude -88° 46' 43.00'' (-88.7787)

Description

3~35' RCDG Spans, Drawing Nos. 10976.

FD04 042 0849 B00084N 10.77

Graves County ~ KY 849 (Folsomdale-Boaz Road) over Mayfield Creek

Geographic Coordinates

Latitude 36° 53' 07.00'' (36.8854)

Longitude -88° 38' 11.00'' (-88.6364)

Description

5~50' RCDG Spans, Drawing Nos. 12891.

FD04 053 1283 B00102N 00.07

Hickman County ~ KY 1283 (Water Valley Road) over JP 9003 (Purchase Parkway)

Geographic Coordinates

Latitude 36° 35' 19.00" (36.5886)

Longitude -88° 49'00.00" (-88.8167)

Description

2~133' PCBB Spans, Drawing No. 16656.

FD04 072 2611 B00029N 00.10

Lyon County ~ KY 2611 (Pleasant Valley Road) over I-69

Geographic Coordinates

Latitude 37° 06' 30.00" (37.1084)

Longitude -88° 00'04.00" (-88.0012)

Description

50'-60'-60'-50' RCDG Spans, Drawing No. 17012.

FD04 073 1322 B00080N 03.95

McCracken County ~ KY 1322 (Lovelaceville Road) over Unnamed Stream

Geographic Coordinates

Latitude 37° 00' 40.00" (37.0111)

Longitude -88° 44'41.00" (-88.7447)

Description

25'-25'-25' RCDG Spans, Drawing No. 12429.

FD04 073 1322 B00081N 03.80

McCracken County ~ KY 1322 (Lovelaceville Road) over Middle Fork Massac Creek

Geographic Coordinates

Latitude 37° 00' 37.00" (37.0103)

Longitude -88° 44'50.00" (-88.7473)

Description

25'-40'-25' RCDG Spans, Drawing No. 12431.

SPECIAL NOTES FOR BRIDGE DECK RESTORATION AND WATERPROOFING

SPECIAL NOTE FOR BRIDGE DECK RESTORATION AND WATERPROOFING
WITH CONCRETE OVERLAYS

SPECIAL NOTE FOR REPLACING EXPANSION JOINTS AND/OR INSTALLING
ARMORED EDGES FOR CONCRETE ON BRIDGES

SPECIAL NOTE FOR ELIMINATING TRANSVERSE JOINTS ON BRIDGES

SPECIAL NOTE FOR DECK DRAIN RETROFIT

SPECIAL NOTE FOR BRIDGE CLEANING AND PREVENTIVE MAINTENANCE

SPECIAL NOTE FOR CONTRACT COMPLETION DATE AND LIQUIDATED
DAMAGES ON BRIDGE REPAIR CONTRACTS

SPECIAL NOTE FOR MAINTAINING AND CONTROLLING TRAFFIC

SPECIAL NOTE FOR BRIDGE DECK RESTORATION AND WATERPROOFING WITH CONCRETE OVERLAYS

1. DESCRIPTION. Perform all work in accordance with the Kentucky Transportation Cabinet, Department of Highway's Standard Specifications for Road and Bridge Construction and applicable Supplemental Specifications, the Standard Drawings (current editions), this Note, and the attached detail drawings. Section references are to the Standard Specifications. This work consists of the following: (1) Furnish all labor, materials, tools, and equipment, (2) Machine prep the existing slab, (3) Complete full-depth and partial depth repairs as directed by the Engineer, (4) Repair/replace damaged and corroded reinforcing bars, (5) Place new concrete overlay and epoxy-sand slurry in accordance with Section 606, (6) Complete asphalt approach pavement and (7) Any other work specified as part of this contract. All construction will be in accordance with Section 606 unless otherwise specified.

2. MATERIALS.

- A. Latex Concrete.** See Section 606.03.17.
- B. Class "M" Concrete.** Use either "M1" or "M2". See Section 601.
- C. Bituminous Asphalt.** Use CL2 ASPH SURF 0.38D PG64-22.
- D. Epoxy-Sand Slurry.** See Section 606.03.10.

3. CONSTRUCTION.

- A. Machine Preparation of Existing Slab.** Remove concrete from existing slab to a depth of at least ¼" below the existing surface, and remove all patches completely, in accordance with the requirements of Section 606.03.03.
- B. Partial Depth Slab Repair and Latex Overlay.** Remove areas determined to be unsound by the Engineer via hydro-demolition or via hand held jackhammers weighing less than 45lbs in accordance with Section 606.02.10 D. Repair/Replace all damaged or severely corroded reinforcing bars prior to partial depth repair operation. The Department will not measure material removal and will consider this work incidental to the bid item "PARTIAL DEPTH PATCHING". Mix and place Latex Modified Concrete Overlay in accordance with Sections 606.03.08 and 606.03.17.
- D. Asphalt Approach Pavement.** Mill each existing asphalt approach for a distance of 50' from the bridge end. Remove the bituminous material uniformly by making an edge key, so as to provide a smooth transition to the finished bridge when a new bituminous overlay of compacted depth of approximately 1½" is added to the approaches. The grinding depth may vary depending of the condition of the existing approach and final elevation of bridge end. Dispose of all removed material away from the site.
- E. Surface Texturing.** Texture the concrete surface of the overlay in accordance with Section 609.03.10.
- F. Verifying Field Conditions.** The Contractor shall field verify all joint openings, locations and manufacture before ordering any material. New material that is unsuitable due to variation in existing structure shall be replaced at the Contractors expense.

- G. Damage to the Structure.** The Contractor shall bear all responsibility and expense for any and all damage to the structure during the repair work even to removal and replacement of a fallen span, should the fallen span result from the Contractor's actions.
- 4. MEASUREMENT.** See Section 606 and the following:
- A. Latex Modified Concrete for Overlay.** The Department will measure the quantity in cubic yards using the theoretical volume as follows for each bridge:
- | | |
|-------------------|---|
| 020B00040N | (99'0"x 24'0"x 1.50") = 11.0 CY |
| 038B00012N | (202'0"x62'0"x1.50") = 58.0 CY |
| 042B00132N | (114'0"x 22'0"x 1.50") = 11.6 CY |
| 042B00084N | (265'0"x24'0"x1.50") = 29.4 CY |
| 053B00102N | (266'0"x26'0"x1.50") = 32.0 CY |
| 072B00029N | (245'0"x24'0"x1.50") = 27.2 CY |
| 073B00080N | (84'0"x24'0"x1.50") = 9.3 CY |
| 073B00081N | (99'0"x24'0"x1.50") = 11.0 CY |
- B. Latex Modified Concrete for Partial Depth Patching and variable thickness of Overlay.** The Department will measure the quantity in cubic yards by deducting the theoretical volume of bridge deck overlay (LMC) from the total volume (as indicated by the batch quantity tickets) of Concrete required to obtain the finished grade shown on the Plans or established by the Engineer.
- C. Machine Prep of Slab.** The Department will measure the machine preparation of the existing bridge deck in square yards, which shall include all labor, equipment, and material needed to complete this work.
- D. Steel Reinforcement.** The Department will measure any reinforcing steel necessary for the partial or full depth patch in pounds, which shall include all labor, equipment, and material needed to complete this work.
- E. Asphalt Approach Pavement.** The Department will measure the quantity in square yards, which shall include all labor, equipment, and material needed to complete this work.
- 5. PAYMENT.** See Section 606 and the following:
- A. Latex Modified Concrete for Overlay.** The Department will make payment for the Latex Modified Concrete under bid item #08534 "CONCRETE OVERLAY – LATEX" for the quantity in cubic yards complete in place.
- B. Latex Modified Concrete for Partial Depth Patching and variable thickness of Overlay.** The Department will make payment for the Partial Depth Patching under bid item #24094EC "PARTIAL DEPTH PATCHING". Payment will be for the quantity per cubic yard complete in place.
- C. Machine Prep of Slab.** The Department will make payment for the removal of the existing overlay under bid item #08551 "MACHINE PREP OF SLAB". Payment will be for the square yard complete.
- D. Remove Existing Overlay.** The Department will make payment for the removal of the existing overlay under the bid item #08510 "REM EPOXY BIT FOREIGN OVERLAY". Payment will be for the square yard complete.

- E. Steel Reinforcement.** The Department will make payment for steel reinforcement, if necessary, under bid item #08150 “STEEL REINFORCEMENT”. Payment will be at the unit price per pound.
- F. Asphalt Approach Pavement.** The Department will make payment for the completed and accepted quantity of this work under the bid item #03304 “BRIDGE OVERLAY APPROACH PAVEMENT”.

SPECIAL NOTE FOR REPLACING EXPANSION JOINTS AND/OR INSTALLING ARMORED EDGES FOR CONCRETE ON BRIDGES

1. DESCRIPTION. Perform all work in accordance with the Kentucky Transportation Cabinet, Department of Highway's Standard Specifications for Road and Bridge Construction and applicable Supplemental Specifications, the Standard Drawings (current editions), this Note, and the attached detail drawings. Section references are to the Standard Specifications. This work consists of the following: (1) Furnish all labor, materials, tools, and equipment, (2) Remove existing concrete and expansion joint(s) and/or bridge ends, (3) Install armored edges, modular expansion joint assembly and new concrete as specified and in accordance with the attached detail drawings, (4) Install new joint seals (where required) and (5) Any other work specified as part of this contract.

2. MATERIALS.

- A. Class "M" Concrete.** Use either "M1" or "M2". See Section 601.
- B. Structural Steel.** Use new, commercial grade steel suitable for welding. The Engineer will base acceptance on visual inspection. See attach detailed drawings
- C. Stud Anchors.** The armored edge stud anchors are 3/4" x 6" embedded stud shear connectors conforming to ASTM A108, Grade 1015
- D. Steel Reinforcement.** Use Grade 60. See Section 602.
- E. Epoxy Bond Coat.** See Section 511.
- F. Joint Seals.**
Pre-compressed Silicon and Hybrid Foam Joint Seals (Parapet and Median). See Section 807.03.02. Choose one from the following list of manufactures:
SSI SES-400
RJ Watson SF-400,
Watson Bowman Acme SF-400
BEJS EMSEAL (4")
DS Brown V-400.
4" Neoprene Strip Seals (Bridge Deck). See Section 807.03.03.

3. EQUIPMENT.

- A. Hammer.** Provide Power driven hammers lighter than nominal 45 lb. class.
- B. Sawing Equipment.** Sawing equipment shall be a concrete saw capable of sawing concrete to the specified depth.
- C. Hydraulic Impact Equipment.** Hydraulic Impact/Skid Steer Type Equipment with a maximum rated striking Energy of 360 ft-lbs are permitted only in areas of concrete removal more than 6 inches away from boundaries of surface areas to remain in service. The Contractor is to provide data information to the engineer on the equipment they wish to utilize to ensure compliance with this note.

4. **CONSTRUCTION.**

- A. Remove Existing Materials.** Remove existing expansion joints, existing modular expansion joint assembly, bridge end armored edges and specified areas of concrete. See attached detail drawings and Standard Drawing BJE-006. Remove debris and/or expansion joint filler as directed by the Engineer. Clean and leave all existing steel reinforcement encountered in place. Damaged steel reinforcement will be repaired/replaced as directed by the Engineer at no additional cost to the Department. Dispose of all removed material entirely away from the job site. This work is incidental to the contract unit price for "Expansion Joint Replacement" or "Armored Edge for Concrete".
- B. Place New Concrete and Armored Edges.** After all specified existing materials have been removed; place new armored edges to match the original grade. See attached detailed drawings and Standard Drawing BJE-006. Place the new Class "M" concrete to the original grade and finish with broom strokes drawn transversely from curb to curb. All new structural steel shall be cleaned and painted in accordance with requirements of Section 607.03.23, except that surfaces to come in contact with concrete are not to be painted. Blast clean all areas of existing concrete and structural steel to come in contact with new concrete until free of all laitance and deleterious substances immediately prior to the placement of the Class "M" Concrete. The surface areas of existing concrete to come in contact with the new Class "M" Concrete are to be coated with an epoxy bond coat immediately prior to placing new concrete in accordance with Section 511. The interfaces of the new and old concrete shall be as nearly vertical and horizontal as possible. Shop drawings will not be required.
- C. Additional Steel Reinforcement.** Furnish for replacement, as directed by the Engineer, 200 linear feet each joint of #4 steel reinforcing bars in 20' lengths. Place these bars in areas deemed by the Engineer to require additional reinforcement. Field cutting and bending is permitted. Do not place any additional steel reinforcement above the height of the top row of Nelson Studs on the armored edges. Ensure that all exposed steel reinforcement is tied in accordance with Section 602.03.04 prior to pouring the new Class "M" concrete. Deliver unused bars to the Local County Maintenance Barn. Payment will be made in accordance with Section 602.
- D. Stage Construction.** Installation of concrete, armored edges and modular expansion joint assembly in two (or more if specified) stages is necessary. Join the armored edges and modular expansion joint assembly at or near the centerline of the roadway or lane line, field weld and grind smooth.
- E. Preformed Neoprene Joint Seal.** Place the preformed joint seal in one continuous, unbroken length. Place neoprene strip seals as recommended by the manufacturer and in accordance with Section 609.03.04 except that shop drawings will not be required.
- F. Pre-compressed Silicone and Foam Hybrid Seals.** Place pre-compressed silicone and foam Hybrid seals as recommended by the manufacturer. Shop drawings will not be required.

- G. Residual Lead.** Residual lead paint may still be on bridge. The Contractor is advised to take all necessary protective measures including worker safety and environmental regulations when performing surface preparation. The Department will not consider any claims based on residual lead paint.
 - H. Verifying Field Conditions.** The Contractor shall field verify all joint openings, locations and manufacture before ordering any material. New material that is unsuitable due to variation in existing structure shall be replaced at the Contractors expense.
 - I. Damage to the Structure.** The Contractor shall bear all responsibility and expense for any and all damage to the structure during the repair work even to removal and replacement of a fallen span, should the fallen span result from the Contractor's actions.
- 5. MEASUREMENT.**
 - A. Expansion Joint Replace 4 In.** The Department will measure the quantity in linear feet from gutter line to gutter line along the centerline of the joint.
 - B. Armored Edge for Concrete.** The Department will measure the quantity in linear feet from gutter line to gutter line along the face of the bridge end.
 - C. Steel Reinforcement.** See Section 602.
- 6. PAYMENT.**
 - A. Expansion Joint Replace 4 In. (03298)** Payment at the contract unit price per linear foot is full compensation for removing specified existing materials, furnishing and installing the new armored edges, concrete, neoprene strip seal (bridge deck), Pre-compressed Silicone and Foam Hybrid Seals (parapets) and all incidental items necessary to complete the work within the specified pay limits as specified by this note and as shown on the attached detail drawings and Standard Drawing BJE-006.
 - B. Armored Edge for Concrete (03299).** Payment at the contract unit price per linear foot is full compensation for placing new armored edge and any approach pavement repair, traffic striping repair and all incidental items necessary to complete the work within the specified pay limits as specified by this note and as shown on the attached detailed drawings and Standard Drawing BJE-006.
 - C. Steel Reinforcement (08150).** See Section 602.

SPECIAL NOTE FOR ELIMINATING TRANSVERSE JOINTS ON BRIDGES

- 1. DESCRIPTION.** Perform all work in accordance with the Kentucky Transportation Cabinet, Department of Highway's Standard Specifications for Road and Bridge Construction and applicable Supplemental Specifications, the Standard Drawings (current editions), this Note, and the Attached Detailed Drawings. Section references are to the Standard Specifications. This work consists of the following: (1) Furnish all labor, materials, tools, and equipment, (2) Remove existing concrete and expansion device(s), (3) Place new concrete and steel reinforcement as specified and (4) Any other work specified as part of this contract. See attached detailed drawings.
- 2. MATERIALS.**
 - A. Class "M" Concrete.** Use either "M1" or "M2". See Section 601.
 - B. Steel Reinforcement.** Use Grade 60. See Section 602.
 - C. Epoxy Bond Coat.** See Section 511.
- 3. EQUIPMENT.**
 - A. Hammer.** See Section 606.02.10 B.
 - B. Sawing Equipment.** See Section 606.02.10 C.
 - C. Hydraulic Impact Equipment.** See Section 606.02.10 D.
- 4. CONSTRUCTION.**
 - A. Remove Existing Materials.** Remove the existing transverse joints, joint filler, and specified areas of concrete as shown on the plans or as directed by the Engineer. Clean and leave all existing steel reinforcement encountered in place. Damaged steel reinforcement will be repaired/replaced as directed by the Engineer at no additional cost to the Department.
Dispose of all removed material entirely away from the job site. This work is incidental to the contract unit price for "Eliminate Transverse Joint".
 - B. Additional Steel Reinforcement.** Furnish for this work steel reinforcing bars as shown on the plans. Splice these bars to the existing longitudinal reinforcement in the deck and curb/sidewalk in the areas of removed concrete to tie the slabs together as shown on the plans. Ensure that all exposed steel reinforcement is tied in accordance with Section 602.03.04 prior to pouring the new Class "M" concrete.
 - C. Place New Concrete.** Blast-clean all areas of existing concrete and structural steel to come in contact with new concrete until free of all laitance and deleterious substances immediately prior to the placement of the Class "M" Concrete. The surface areas of existing concrete to come in contact with the new Class "M" Concrete are to be coated with an epoxy bond coat immediately prior to placing new concrete in accordance with Section 511. The interfaces of the new and old concrete shall be as nearly vertical and horizontal as possible. Place new Class "M" Concrete to the specified grade and finish to receive the new overlay or as shown on the plans. On the sidewalk and curb, place the new concrete to original grade and finish to match the existing curb/sidewalk. Repair all pavement striping that is disturbed.
 - D. Stage Construction.** Installation of concrete in two (or more if specified) stages is necessary.

- E. Residual Lead.** Residual lead paint may still be on bridge. The Contractor is advised to take all necessary protective measures including worker safety and environmental regulations when performing surface preparation. The Department will not consider any claims based on residual lead paint.
- F. Verifying Field Conditions.** The Contractor shall field verify all dimensions before ordering any material. New material that is unsuitable due to variation in existing structure shall be replaced at the Contractors expense.
- G. Damage to the Structure.** The Contractor shall bear all responsibility and expense for any and all damage to the structure during the repair work even to removal and replacement of a fallen span, should the fallen span result from the Contractor's actions.

5. MEASUREMENT.

- A. Eliminate Transverse Joint.** The Department will measure the quantity in linear feet from plinth to plinth along the centerline of the joint.
- B. Steel Reinforcement.** See Section 602.

6. PAYMENT.

- A. Eliminate Transverse Joint (03300).** Payment at the contract unit price per linear foot is full compensation for furnishing equipment, labor, tools and materials needed to complete removal and disposal of the specified existing materials, cleaning and straightening of existing steel reinforcement, furnishing and installing the concrete, repairing traffic striping and all incidental items necessary to complete the work within the specified pay limits as specified by this note and as shown on the attached detail drawings.
- B. Steel Reinforcement (08150).** See Section 602.

SPECIAL NOTES FOR DECK DRAIN RETROFIT

1. **DESCRIPTION.** Perform all work in accordance with the Kentucky Transportation Cabinet, Department of Highway's Standard Specifications for Road and Bridge Construction and applicable Supplemental Specifications, the Standard Drawings, (current editions), this note, and the attached detail drawings. This work consists of: (1) Furnish all labor, materials, tools, and equipment, (2) Install Deck Drain Retrofit and (3) Any other work specified as part of this contract.

2. **MATERIALS**

- A. **Poly-methyl Methacrylate (PMMA).** Use new, commercial grade, ¼" thick Poly-methyl methacrylate known as acrylic glass or its various trade names, like Plexiglass®. The Engineer will base acceptance on visual inspection.
- B. **Anchors.** Will allow galvanized all-thread ½"x6" or an approved alternate.
- C. **Grout.** See Section 511.

3. **CONSTRUCTION**

- A. **Install Deck Drain Retrofit.** Place PMMA glass as shown in attached detail drawing.
- B. **Clean Deck Drains.** All deck drains shall be clean of debris. All cost to clean the deck drains shall be considered incidental to the unit price bid for deck drain retrofit.

4. **MEASUREMENT**

- A. **Deck Drain Retrofit.** The Department will measure this quantity as each.

5. **PAYMENT**

- A. **Deck Drain Retrofit (24692EC).** Payment at the contract unit price per each is full compensation for furnishing and installing new acrylic glass panels, and all incidental items necessary to complete the work within the specified pay limits as specified by this note and as shown on the attached detail drawing.

SPECIAL NOTE FOR PREVENTIVE MAINTENANCE

1. DESCRIPTION.

Perform all work in accordance with the Kentucky Transportation Cabinet, Department of Highway's Standard Specifications for Road and Bridge Construction and applicable Supplemental Specifications, the Standard Drawings, (current editions), this Note and Attached Detailed Drawings. Section references are to the Standard Specifications. This work consists of the following: (1) Furnish all labor, materials, tools, and equipment, (2) Bridge Cleaning, (3) Pressure Washing, (4) Concrete Coatings and (5) Any other work specified as part of this contract.

2. MATERIALS.

A. Wash Water

Use clean potable water for all pressure washing.

B. Concrete Coatings

See The Division of Material's list of approved materials for concrete coatings and Section 821.

C. Bearing Lubricant

Use one of the lubricants from the following manufactures:

Manufacture

Bostik Inc.,

Mobil Oil

Certified Labs

Lubricant

Never Seez - Mariner's Choice

Mobil Centaur Moly NLGI Grades 1 or 2

Premalube #1 WG

3. CONSTRUCTION.

A. Bridge Cleaning.

All debris shall be removed from the bridge components. See attached detailed drawings for each bridge addressing components having debris removal. Equipment for removing debris from the bridge components shall be determined by the Contractor, subject to the approval of the Engineer. The Contractor shall prevent any debris from entering any body of water, bridge drainage system, or traffic lanes. All debris removed shall be disposed of in a suitable off-site disposal facility. Prior to all cleaning work, the Contractor shall confirm that any bridge drainage system is not blocked by un-removable debris. A blocked drainage system is considered to be one from which debris cannot be removed using the means specified in this note. If the Engineer has been notified, and concurs that the drainage system is blocked prior to performing other cleaning work, then proceed at the direction of the engineer. If the Contractor does not inspect the bridge drainage system and notify the engineer prior to beginning work any blocked drains will be considered to be the result of the Contractor's operations, and all clearing and cleaning of the drainage system shall be done as part of the work of the specification. All vegetation present at areas of the bridge that are to be addressed in this proposal shall be removed as determined by the Engineer.

All cost to complete Debris Removal, Clean Deck Drains and Remove Vegetation shall as specified shall be included in the Lump Sum price for "Bridge Cleaning".

B. Stratified and Pack Rust Removal.

Stratified and pack rust shall be removed from all bearing devices. All existing bearing lubrication shall be removed. See attached detailed drawings for each bridge showing location and quantity of the bearing devices. Hand tools including wire brushes, scrapers or impact devices (hand hammers or power chisels) are to be used for removing stratified and pack rust. All surfaces to have stratified and pack rust removed shall be cleaned to an SSPC SP-2 level. All debris collected shall be disposed of in a suitable off-site disposal facility. **All cost to complete Stratified, Pack Rust Removal and removal of existing bearing lubricant shall be considered incidental to the unit price bid for "Lubricate Bearing".**

C. Pressure Washing.

Specified bridge components shall be pressure washed. See attached detailed drawings for each bridge addressing components to be pressure washed. All equipment for pressure washing shall be operated at a minimum pressure of up 4,000 psi with 0 degree spinner tip and/or fan tips as determined by the engineer at the working location with a minimum flow rate of 3.5 gal/minute provided that these pressures do not damage any components of the structure. Pressure and flow rates shall be reduced to a level satisfactory to the Engineer should any damage occur due to power washing procedures. Pressure washing shall be operated at distance of approximately six inches from and perpendicular to the surface. All pressure washing wands shall be equipped with a gauge to accurately determine the amount pressure used. Pressure washing of any bridge element will proceed from top of wash area to bottom of wash area. Wash water will not be released to a bridge element previously washed. Perform all pressure washing at temperatures above 40 degrees Fahrenheit.

All cost to complete Pressure Washing as specified shall be included in the Lump Sum price for Lump Sum price for "Bridge Cleaning".

D. Concrete Coatings Application.

Specified bridge components shall have concrete coating applied to as specified after debris removal and power washing. See attached detailed drawings for addressing the bridge components. Use compressed air to remove any loose debris from the surfaces that are to be coated after power washing. See concrete coating diagram.

All coatings shall be applied within manufacturers recommended dry film thickness range. For recommended conditions for application, see Section 614.03.02 and coatings supplier specifications. Allow the surfaces to be coated to dry before any coating is applied. The coating must be applied to a clean and dry surface. All coating application shall be executed using brushes, rollers, etc. No spray application will be permitted.

The Department requires acceptance testing of samples obtained on a per-lot basis per-shipment. The Division of Materials will perform acceptance testing. See Section 821.04.

The finish coat shall be Light Gray for Concrete. See Section 821.02.

All cost to complete Concrete Coating Application as specified shall be included in the Lump Sum price for "Concrete Coatings".

E. Bearing Lubrication Application.

Bearing devices shall be lubricated as specified after all stratified rust and pack rust is removed and power washing is complete, bearing devices shall have lubricant applied to all surfaces of the bearing including bearing plates and points of movement. See attached detailed drawings for each bridge showing location and quantity of the bearing devices. Allow bearing devices to dry before lubricant is applied. Perform all bearing lubrication application at temperatures above 40 degrees Fahrenheit or in accordance with manufacturer's specifications. **All cost to complete Bearing Lubrication Application as specified shall be included in the unit price Each for "Lubricate Bearing"**

F. Sequence of Work.

Complete work in the sequence listed below:

1. Debris Removal
2. Stratified Rust Removal
3. Pressure Washing
4. Concrete Coating Application
5. Bearing Lubrication Application

G. Inspection.

The Cabinet will provide inspection for all items required in this contract. Visual inspection will be required upon completion of each work item for each structure component or at the discretion of the Engineer at any time. All visual inspection shall be performed within arm's length distance.

1. **Debris Removal:** Visual Inspection.
2. **Stratified Rust or Pack Rust Removal:** Visual Inspection and Scraper
Test any surface cleaned to SSPC SP2 will be inspected by a dull scraper test to ascertain adherence of existing coating and a hammer test for tightness of pack rust.
3. **Power Washing:** Visual Inspection.
4. **Concrete Coating:**
Prime Coat Application Check for wet film thickness*, and defects in the Paint.
Finish Coat Application Check for wet film thickness*, paint appearance, color and quality of application.

H. Verifying Field Conditions.

The Contractor shall be familiar with all conditions at each bridge site. The Cabinet will not consider any claims due to the Contractor having not familiarized themselves with requirements of this work.

I. Residual Lead.

Residual lead paint may still be on bridge. The Contractor is advised to take all necessary protective measures including worker safety and environmental regulations when performing surface preparation. The Department will not consider any claims based on residual lead paint.

J. Damage to the structure.

The Contractor shall bear all responsibility and expense for any and all damage to the structure during the repair work, even to the removal and replacement of a fallen span, should the fallen span result from the Contractor's actions.

4. MEASUREMENT.

A. Bridge Cleaning.

The Cabinet will measure this item by Lump Sum, completed and accepted.

B. Concrete Coating.

The Cabinet will measure this item by Lump Sum, completed and accepted.

C. Bearing Lubrication: The Cabinet will measure this item by Each, completed and accepted.

5. PAYMENT.

A. Bridge Cleaning (24981EC).

Payment at the contract unit price for “Lump Sum” is full compensation for Debris Removal, Deck Drain Cleaning, Pressure Washing and all incidental items required to complete this with as specified in this note and attached detailed drawings.

B. Concrete Coating (24982EC).

Payment at the contract unit price for “Lump Sum” is full compensation for applying the concrete coatings and all incidental items required to complete this work as specified in this note and attached detailed drawings.

C. Bearing Lubrication (24983EC): Payment at the contract unit price “Each” is full compensation for applying bearing lubrication and all incidental items required to complete this work as specified in this note and attached detailed drawings.

**SPECIAL NOTE FOR CONTRACT COMPLETION DATE AND
LIQUIDATED DAMAGES ON BRIDGE REPAIR CONTRACTS**

1. **COMPLETION DATE.** The Contractor has the option of selecting the starting date for this Contract. Once selected, notify the Department in writing of the date selected at least two weeks prior to beginning work. All work is to be completed by the date listed below. An allotted number of Calendar days are assigned to each structure in this contract as shown below.

<u>STRUCTURE</u>	<u>NO. OF CALENDAR DAYS</u>	<u>COMPLETION DATE</u>
020B00040N	30	November 30, 2021
038B00012N	30	November 30, 2021
042B00132N	30	November 30, 2021
042B00084N	30	November 30, 2021
053B00102N	30	November 30, 2021
072B00029N	30	November 30, 2021
073B00080N	30	November 30, 2021
073B00081N	30	November 30, 2021

Contrary to Section 108.07.02, the Engineer will begin charging calendar days for a structure on the day the Contractor starts work or sets up traffic control on that particular structure.

2. **LIQUIDATED DAMAGES.** Liquidated damages will be assessed the Contractor in accordance with the Transportation Cabinet, Department of Highway's Standard Specifications for Road and Bridge Construction (current edition), Section 108.09, when either the allotted number of calendar days or the November 30, 2021 date is exceeded.

Contrary to the Standard Specifications, liquidated damages will be assessed the Contractor during the months of December, January, February and March when the contract time has expired on any individual bridge or bridges. Contract time will be charged during these months.

All construction must be completed in accordance with the weather limitations specified in Section 606 and/or Section 601 as applicable. No extension of Contract time will be granted due to inclement weather or temperature limitations that occur due to starting work on the Contract or a structure late in the construction season.

SPECIAL NOTE FOR TRAFFIC CONTROL ON BRIDGE REPAIR CONTRACTS

1. TRAFFIC CONTROL GENERAL

Except as provided herein, traffic shall be maintained in accordance with the Standard Specifications (current edition), Section 112. Except for the roadway and traffic control bid items listed, all items of work necessary to maintain and control traffic will be paid at the lump sum bid price to "Maintain and Control Traffic". Contrary to Section 106.01, traffic control devices used on this project may be new or used in new condition, at the beginning of the work and maintained in like new condition until completion of the work.

2. TRAFFIC COORDINATOR

Furnish a Traffic Coordinator as per Section 112. The Traffic Coordinator shall inspect the project maintenance of traffic, at least three times daily, or as directed by the Engineer, during the Contractor's operations and at any time a lane closure is in place. The personnel shall have access on the project to a radio or telephone to be used in case of emergencies or accidents. The Traffic Coordinator shall report all incidents throughout the work zone to the Engineer on the project. The Contractor shall furnish the name and telephone number where the Traffic Coordinator can be contacted at all times.

3. SIGNS

Contrary to Section 112.04.02, only long term signs (sign intended to be continuously in place for more than 3 days) will be measured for payment; short term signs (signs intended to be left in place for 3 days or less) will not be measured for payment but will be incidental to Maintain and Control Traffic.

The contractor is to install warning signs for wide loads in advance of the bridge under the direction of the Engineer. The Department will not measure installation, maintenance, or removal for payment, and will consider these incidentals to Maintain and Control Traffic.

4. TEMPORARY PAVEMENT STRIPING

Skip lines and/or solid lines through the length of the tapers for lane closures and other striping as directed by the Engineer shall be temporarily covered with 6" black removable tape. Permanent removal of all other pavement striping for traffic control shall be considered incidental to Maintain and Control Traffic. Temporary pavement striping shall be paid only once per course in accordance with Section 112.04.07. The Contractor shall replace any temporary striping that becomes damaged or fails to adhere to the pavement before dark on the day of the notification. Liquidated damages shall be assessed to the Contractor at a rate of \$500 per day for failing to replace temporary striping within this time limit.

5. PROJECT PHASING & CONSTRUCTION PROCEDURES

Maintain one lane of traffic on each bridge at all times in accordance with Standard Drawing No. TTC-110 for lane closures. The minimum clear lane width required is as follows:

<u>Structure</u>	<u>Clear Lane Width</u>
020B00040N	12'-0"
038B00012N	12'-0"
042B00132N	11'-0"
042B00084N	12'-0"
053B00102N	13'-0"
072B00029N	12'-0"
073B00080N	12'-0"
073B00081N	12'-0"

6. TEMPORARY SIGNAL

Provide, install, and maintain a temporary traffic signal as specified below. The Contractor must provide a 24-hour contact person and number available to maintain the temporary signals as needed.

<u>Structure</u>	<u>Signal</u>
020B00040N	2 Phase
042B00084N	2 Phase
042B00132N	2 Phase
053B00102N	2 Phase
072B00029N	2 Phase
073B00081N	2 Phase
073B00081N	2 Phase

7. ADDITIONAL LANE CLOSURES

Shoulder and single will be permitted for structures crossing I-69 for any necessary work below the structure. These shoulder and lane closures will be determined by the Engineer. All shoulder and lane closures shall be removed when not working. All cost shall be considered incidental to the lump sum bid for Maintain and Control Traffic.

9. LANE SHIFT FOR PHASED CONSTRUCTION 038B00012N

Traffic shall be shifted to each side of the bridge for all work. All temporary striping and traffic cone placement will be determined by the Engineer. All traffic cones used will be consider incidental the lump sum bid for "Maintain and Control Traffic".

8. MEASUREMENT.

Temporary Signs:

The Cabinet will measure this item by "Square Feet".

Maintain and Control Traffic:

The Cabinet will measure this item by "Lump Sum".

Lane Closure and Temp Signal 2 Phase:

The Cabinet will measure this item by "Each".

Pave Striping-Temp Rem Tape-B, W, and Y:

The Department will measure the quantity in "Linear Feet".

9. PAYMENT.

Temporary Signs (02562)

Payment at the contract unit price for "Square Feet" is full compensation for all items to complete this work as specified.

Maintain and Control Traffic (02650):

Payment at the contract unit price for "Lump Sum" is full compensation for all items to complete this work as specified.

Lane Closure (02653) and Temp Signal 2 Phase (04933):

Payment at the contract unit price "Each" is full compensation for all items to complete this work as specified.

Pave Striping-Temp Rem Tape-B (06549), W (06550), and Y (06551):

Payment at the contract unit price "Lineal Feet" is full compensation for all items to complete this work as specified.



COMMONWEALTH OF KENTUCKY
TRANSPORTATION CABINET
transportation.ky.gov

Andy Beshear
GOVERNOR

Jim Gray
SECRETARY

Asbestos Inspection Report

To: Tom Mathews

District: Central Office

Date: February 9, 2021

Conducted By: O'Dail Lawson

Report Prepared By: O'Dail Lawson

Project and Structure Identification

Project Number: CID 212952

Structure ID: Carlisle 020B00040N

Structure Location: KY-1371 over unnamed stream

Sample Description: Any suspect materials collected were negative for asbestos.

Inspection Date: February 3, 2021

Results and Recommendations

The results of the samples collected were negative for the presence of asbestos above 1%.
No abatement is required at this time.

It is recommended that this report accompany the 10-Day Notice of Intent for Demolition ([DEP7036Form](#)) which is to be submitted to the Kentucky Division of Air Quality prior to abatement, demolition, or renovation of any building or structure in the Commonwealth.

MRS, Inc. Analytical Laboratory Division

(502) 495-1212
Fax: (502) 491-7111

BULK SAMPLE ASBESTOS ANALYSIS

Analysis N#	# 3102092	Address:	Carlisle : 020 B00040 N
Client Name:	K Y T C		
Sampled By:	O'Dail Lawson		

[illegible]

Reviewed By: Winters Mena
Signature

The test relates only to the items tested. This report does not represent endorsement by NVLAP or any agency of the U.S. Government. Partial Reproduction of any part of this report is strictly prohibited. Samples shall be retained for (30) days.

AJHA #1 02459

KYTC COC

ENVIRONMENTAL TRAINING CONCEPTS, INC
P.O Box 99603 Louisville, KY 40269
(502)640-2951

Certification Number: ETC-AIR-031120-00387

O'Dail Lawson

has on 03-11-2020, attended and successfully completed the requirements and passed the examination with a score of 70% of better on the entitled course.

ASBESTOS INSPECTOR REFRESHER

Training was in accordance with 40 CFR Part 763 (AHERA) approved by the Commonwealth of Kentucky, the Indiana Department of Environmental Management, Tennessee Department of Environment & Conservation and The Arkansas Department of Environmental Quality. The above student received requisite training for Asbestos Accreditation under Title II of the Toxic Substance Act (TSCA).

Conducted at: 1520 Alliant Ave., Louisville, KY

Name:  Training Manager

Expiration Date: 03-11-2021

Name:  Instructor



COMMONWEALTH OF KENTUCKY
TRANSPORTATION CABINET
transportation.ky.gov

Andy Beshear
GOVERNOR

Jim Gray
SECRETARY

Asbestos Inspection Report

To: Tom Mathews

District: Central Office

Date: February 9, 2021

Conducted By: O'Dail Lawson

Report Prepared By: O'Dail Lawson

Project and Structure Identification

Project Number: CID 212952

Structure ID: Fulton 038B00012N

Structure Location: US-0051 (Nolan Avenue) over Jackson Purchase Parkway

Sample Description: Any suspect materials collected were negative for asbestos.

Inspection Date: February 3, 2021

Results and Recommendations

The results of the samples collected were negative for the presence of asbestos above 1%.
No abatement is required at this time.

It is recommended that this report accompany the 10-Day Notice of Intent for Demolition ([DEP7036Form](#)) which is to be submitted to the Kentucky Division of Air Quality prior to abatement, demolition, or renovation of any building or structure in the Commonwealth.

MRS, Inc. Analytical Laboratory Division

(502) 495-1212
Fax: (502) 491-7111

BULK SAMPLE ASBESTOS ANALYSIS

Analysis N#	# 3102093	Address:	Fulton County - 038 B00018 N
Client Name:	K Y T C		
Sampled By:	O'Dail Lawson		

[illegible]

Methodology : EPA Method 600/R-93-116

Date Analyzed : 9-Feb-21

Analyst : Winterford Mensah

Reviewed By: Wintgers Mencia
Signature

The test relates only to the items tested. This report does not represent endorsement by NVLAP or any agency of the U.S. Government. Partial Reproduction of any part of this report is strictly prohibited. Samples shall be retained for (30) days.

AIHA # 102459

AJHA #1 02459

MRS, INC.

MRS, Inc. Analytical Laboratory Division

332 West Broadway, S Suite # 902
Louisville, Kentucky 40202

Phone # : (502) 495-1212
E-Mail Address : CEOMRSInc@AOL.Com

Client:	KYTC	Project No:	# 3102092 B
Address:	200 Mero Street	Sample ID:	# 12 - 1
	Frankfort, KY	Sampled:	3-Feb-21
	40601	Received:	5-Feb-21
		Analyzed:	9-Feb-21 - Point Count -
	Attention : O'Dail Lawson		

Bulk Sample Analysis

Sampled By : O'Dail Lawson

Facility/Location: Fulton County - 038 B 00012N

Field Description: Guard Rail Mastic

Laboratory Description:

Gray Material

Asbestos Materials:

Chrysotile = 1/400 = 0.25 % (< 1 %) Sample Is Negative

Non-Asbestos Fibrous Materials :

Cellulose 0.25 %

Binders 99.50 %

Remarks: The sample was analyzed for asbestos content following the EPA Methodology (600/R-93/116). The test relates only to the items tested. This report does not represent endorsement by NVLAP or any agency of the U.S. Government.

Analyst: Winterford Mensah

Reviewed By:

Winterford Mensah
Signature

AIHA #102459

/

AIHA #102459

/

AIHA #102459

KYTC COC

ENVIRONMENTAL TRAINING CONCEPTS, INC
P.O Box 99603 Louisville, KY 40269
(502)640-2951

Certification Number: ETC-AIR-031120-00387

O'Dail Lawson

has on 03-11-2020, attended and successfully completed the requirements and passed the examination with a score of 70% of better on the entitled course.

ASBESTOS INSPECTOR REFRESHER

Training was in accordance with 40 CFR Part 763 (AHERA) approved by the Commonwealth of Kentucky, the Indiana Department of Environmental Management, Tennessee Department of Environment & Conservation and The Arkansas Department of Environmental Quality. The above student received requisite training for Asbestos Accreditation under Title II of the Toxic Substance Act (TSCA).

Conducted at: 1520 Alliant Ave., Louisville, KY

Name:  Training Manager

Expiration Date: 03-11-2021

Name:  Instructor



COMMONWEALTH OF KENTUCKY
TRANSPORTATION CABINET
transportation.ky.gov

Andy Beshear
GOVERNOR

Jim Gray
SECRETARY

Asbestos Inspection Report

To: Tom Mathews

District: Central Office

Date: February 9, 2021

Conducted By: O'Dail Lawson

Report Prepared By: O'Dail Lawson

Project and Structure Identification

Project Number: CID 212952

Structure ID: Graves 042B00084N

Structure Location: KY-0849 over Mayfield Creek

Sample Description: Any suspect materials collected were negative for asbestos.

Inspection Date: February 3, 2021

Results and Recommendations

The results of the samples collected were negative for the presence of asbestos above 1%.
No abatement is required at this time.

It is recommended that this report accompany the 10-Day Notice of Intent for Demolition ([DEP7036Form](#)) which is to be submitted to the Kentucky Division of Air Quality prior to abatement, demolition, or renovation of any building or structure in the Commonwealth.

MRS, Inc. Analytical Laboratory Division

(502) 495-1212
Fax: (502) 491-7111

Analysis N#	# 3102094	Address:	Graves County 042 B00084N
Client Name:	K Y T C		
Sampled By:	O'Dail Lawson		

[illegible]

Date Analyzed : 9-Feb-21

Analyst : Winterford Mensah

Reviewed By:

Winterson Mendez
Signature

The test relates only to the items tested. This report does not represent endorsement by NVLAP or any agency of the U.S. Government. Partial Reproduction of any part of this report is strictly prohibited. Samples shall be retained for (30) days.

AJHA #1 02459

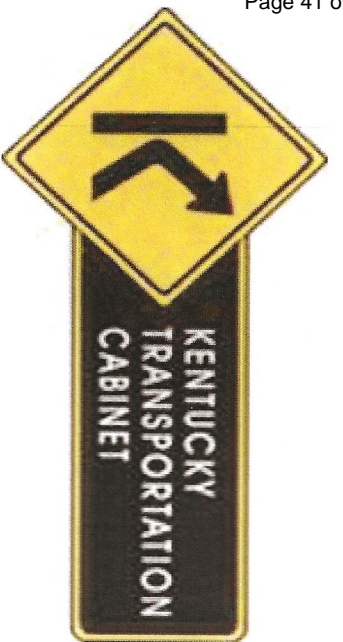

Chain of Custody Record

Kentucky Transportation Cabinet

200 Mero Street, 5th Floor West

Frankfort, Kentucky 40622

(502) 564-7250 fax (502) 564-5655

O'Dail Lawson KYTC 200 Mero Street Frankfort KY Phone: 502-782-5020 Fax: 502-564-5655 PO#:		Client Information Results Code: KY TRANSPORTATION CABINET	
Project ID Graves 042B00084N		Sampers (signature): C/O 21-2961	
Sample ID 84-1		Sample Description Joint compound	
Collected Date 2/3/91		Time 13:30	
Analysis Requested Asbestos bulk		Matrix ?	
Color black		Cont. Type N/A	
Preservative			
Relinquished By:		Date/Time:	
Received By:		Date/Time:	
Relinquished By:		Date/Time:	
Received at Lab By:		Date/Time:	

ENVIRONMENTAL TRAINING CONCEPTS, INC
P.O Box 99603 Louisville, KY 40269
(502)640-2951

Certification Number: ETC-AIR-031120-00387

O'Dail Lawson

has on 03-11-2020, attended and successfully completed the requirements and passed the examination with a score of 70% of better on the entitled course.

ASBESTOS INSPECTOR REFRESHER

Training was in accordance with 40 CFR Part 763 (AHERA) approved by the Commonwealth of Kentucky, the Indiana Department of Environmental Management, Tennessee Department of Environment & Conservation and The Arkansas Department of Environmental Quality. The above student received requisite training for Asbestos Accreditation under Title II of the Toxic Substance Act (TSCA).

Conducted at: 1520 Alliant Ave., Louisville, KY

Name:  Training Manager

Expiration Date: 03-11-2021

Name:  Instructor



COMMONWEALTH OF KENTUCKY
TRANSPORTATION CABINET
transportation.ky.gov

Andy Beshear
GOVERNOR

Jim Gray
SECRETARY

Asbestos Inspection Report

To: Tom Mathews

District: Central Office

Date: February 9, 2021

Conducted By: O'Dail Lawson

Report Prepared By: O'Dail Lawson

Project and Structure Identification

Project Number: CID 212952

Structure ID: Graves 042B00132N

Structure Location: KY-0339 over Goose Creek

Sample Description: Any suspect materials collected were negative for asbestos.

Inspection Date: February 3, 2021

Results and Recommendations

The results of the samples collected were negative for the presence of asbestos above 1%.
No abatement is required at this time.

It is recommended that this report accompany the 10-Day Notice of Intent for Demolition ([DEP7036Form](#)) which is to be submitted to the Kentucky Division of Air Quality prior to abatement, demolition, or renovation of any building or structure in the Commonwealth.

MRS, Inc. Analytical Laboratory Division

(502) 495-1212

Fax: (502) 491-7111

BULK SAMPLE ASBESTOS ANALYSIS

Analysis N#	# 3102095	Address:	Graves County 042 B00132N
Client Name:	K Y T C		
Sampled By:	O'Dail Lawson		

[illegible]

Methodology : EPA Method 600/R-93-116

Date Analyzed : 9-Feb-21

Analyst : Winterford Mensah

Reviewed By: Wintgers Mensaf
Signature

The test relates only to the items tested. This report does not represent endorsement by NVLAP or any agency of the U.S. Government. Partial Reproduction of any part of this report is strictly prohibited. Samples shall be retained for (30) days.

AIHA # 102459

AJHA #1 02459

ENVIRONMENTAL TRAINING CONCEPTS, INC
P.O Box 99603 Louisville, KY 40269
(502)640-2951

Certification Number: ETC-AIR-031120-00387

O'Dail Lawson

has on 03-11-2020, attended and successfully completed the requirements and passed the examination with a score of 70% of better on the entitled course.

ASBESTOS INSPECTOR REFRESHER

Training was in accordance with 40 CFR Part 763 (AHERA) approved by the Commonwealth of Kentucky, the Indiana Department of Environmental Management, Tennessee Department of Environment & Conservation and The Arkansas Department of Environmental Quality. The above student received requisite training for Asbestos Accreditation under Title II of the Toxic Substance Act (TSCA).

Conducted at: 1520 Alliant Ave., Louisville, KY

Name:  Training Manager

Expiration Date: 03-11-2021

Name:  Instructor



COMMONWEALTH OF KENTUCKY
TRANSPORTATION CABINET
transportation.ky.gov

Andy Beshear
GOVERNOR

Jim Gray
SECRETARY

Asbestos Inspection Report

To: Tom Mathews

District: Central Office

Date: February 9, 2021

Conducted By: O'Dail Lawson

Report Prepared By: O'Dail Lawson

Project and Structure Identification

Project Number: CID 212952

Structure ID: Hickman 053B00102N

Structure Location: KY-1283 (State Route 1283) over Jackson Purchase Parkway

Sample Description: Any suspect materials collected were negative for asbestos.

Inspection Date: February 3, 2021

Results and Recommendations

The results of the samples collected were negative for the presence of asbestos above 1%.
No abatement is required at this time.

It is recommended that this report accompany the 10-Day Notice of Intent for Demolition ([DEP7036Form](#)) which is to be submitted to the Kentucky Division of Air Quality prior to abatement, demolition, or renovation of any building or structure in the Commonwealth.

MRS, Inc. Analytical Laboratory Division

(502) 495-1212
Fax: (502) 491-7111

BULK SAMPLE ASBESTOS ANALYSIS

Analysis N#	# 3102096	Address:	Hickman - 053 B00102N
Client Name:	K Y T C		
Sampled By:	O'Dail Lawson		

[illegible]

Reviewed By: Winters Mena
Signature

The test relates only to the items tested. This report does not represent endorsement by NVLAP or any agency of the U.S. Government. Partial Reproduction of any part of this report is strictly prohibited. Samples shall be retained for (30) days.

AJHA #1 02459

MRS, INC.

MRS, Inc. Analytical Laboratory Division

332 West Broadway, S Suite # 902
Louisville, Kentucky 40202

Phone # : (502) 495-1212
E-Mail Address : CEOMRSInc@AOL.Com

Client:	KYTC	Project No:	# 3102096 B
Address:	200 Mero Street	Sample ID:	# 102 - 2
	Frankfort, KY	Sampled:	3-Feb-21
	40601	Received:	5-Feb-21
		Analyzed:	9-Feb-21 - Point Count -
	Attention : O'Dail Lawson		

Bulk Sample Analysis

Sampled By : O'Dail Lawson

Facility/Location: Hickman - Item # 053B00102N

Field Description: Guard Rail Mastic

Laboratory Description:

Gray Material

Asbestos Materials:

Chrysotile = 1/400 = 0.25 % (< 1 %) Sample Is Negative

Non-Asbestos Fibrous Materials :

Cellulose 0.25 %

Binders 99.50 %

Remarks: The sample was analyzed for asbestos content following the EPA Methodology (600/R-93/116). The test relates only to the items tested. This report does not represent endorsement by NVLAP or any agency of the U.S. Government.

Analyst: Winterford Mensah

Reviewed By: 
Signature

AIHA #102459

/

AIHA #102459

/

AIHA #102459

KYTC COC

ENVIRONMENTAL TRAINING CONCEPTS, INC
P.O Box 99603 Louisville, KY 40269
(502)640-2951

Certification Number: ETC-AIR-031120-00387

O'Dail Lawson

has on 03-11-2020, attended and successfully completed the requirements and passed the examination with a score of 70% of better on the entitled course.

ASBESTOS INSPECTOR REFRESHER

Training was in accordance with 40 CFR Part 763 (AHERA) approved by the Commonwealth of Kentucky, the Indiana Department of Environmental Management, Tennessee Department of Environment & Conservation and The Arkansas Department of Environmental Quality. The above student received requisite training for Asbestos Accreditation under Title II of the Toxic Substance Act (TSCA).

Conducted at: 1520 Alliant Ave., Louisville, KY

Name:  Training Manager

Expiration Date: 03-11-2021

Name:  Instructor



COMMONWEALTH OF KENTUCKY
TRANSPORTATION CABINET
transportation.ky.gov

Andy Beshear
GOVERNOR

Jim Gray
SECRETARY

Asbestos Inspection Report

To: Tom Mathews

District: Central Office

Date: February 9, 2021

Conducted By: O'Dail Lawson

Report Prepared By: O'Dail Lawson

Project and Structure Identification

Project Number: CID 212952

Structure ID: Lyon 072B0029N

Structure Location: KY-2611 (State Route 2611) over I-69

Sample Description: Any suspect materials collected were negative for asbestos.

Inspection Date: February 3, 2021

Results and Recommendations

The results of the samples collected were negative for the presence of asbestos above 1%.
No abatement is required at this time.

It is recommended that this report accompany the 10-Day Notice of Intent for Demolition ([DEP7036Form](#)) which is to be submitted to the Kentucky Division of Air Quality prior to abatement, demolition, or renovation of any building or structure in the Commonwealth.

MRS, INC.

MRS, Inc. Analytical Laboratory Division

332 West Broadway, S Suite # 902
Louisville, Kentucky 40202

Phone # : (502) 495-1212
E-Mail Address : CEOMRSInc@AOL.Com

Client: KYTC
Address: 200 Mero Street
Frankfort, KY
40601
Attention : O'Dail Lawson

Project No: # 3102097B
Sample ID: # 29 - 1
Sampled: 3-Feb-21
Received: 5-Feb-21
Analyzed: 9-Feb-21 - Point Count -

Bulk Sample Analysis

Sampled By : O'Dail Lawson

Facility/Location: Lyon - 072B00029N

Field Description: Guard Rail Mastic

Laboratory Description:

Gray Material

Asbestos Materials:

Chrysotile = 1/400 = 0.25 % (< 1 %) Sample Is Negative

Non-Asbestos Fibrous Materials :

Cellulose 0.25 %

Binders 99.50 %

Remarks: The sample was analyzed for asbestos content following the EPA Methodology (600/R-93/116). The test relates only to the items tested. This report does not represent endorsement by NVLAP or any agency of the U.S. Government.

Analyst: Winterford Mensah

Reviewed By: 
Signature

AIHA #102459

/

AIHA #102459

/

AIHA #102459

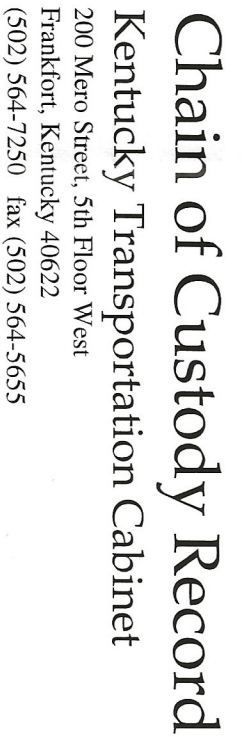
KYTC COC

ENVIRONMENTAL TRAINING CONCEPTS, INC
P.O Box 99603 Louisville, KY 40269
(502)640-2951

Certification Number: ETC-AIR-031120-00387

O'Dail Lawson

has on 03-11-2020, attended and successfully completed the requirements and passed the examination with a score of 70% of better on the entitled course.

ASBESTOS INSPECTOR REFRESHER

Training was in accordance with 40 CFR Part 763 (AHERA) approved by the Commonwealth of Kentucky, the Indiana Department of Environmental Management, Tennessee Department of Environment & Conservation and The Arkansas Department of Environmental Quality. The above student received requisite training for Asbestos Accreditation under Title II of the Toxic Substance Act (TSCA).

Conducted at: 1520 Alliant Ave., Louisville, KY

Name:  Training Manager

Expiration Date: 03-11-2021

Name:  Instructor



COMMONWEALTH OF KENTUCKY
TRANSPORTATION CABINET
transportation.ky.gov

Andy Beshear
GOVERNOR

Jim Gray
SECRETARY

Asbestos Inspection Report

To: Tom Mathews

District: Central Office

Date: February 9, 2021

Conducted By: O'Dail Lawson

Report Prepared By: O'Dail Lawson

Project and Structure Identification

Project Number: CID 212952

Structure ID: McCracken 073B00080N

Structure Location: KY-1322 (Lovelaceville Road) over unnamed stream

Sample Description: Any suspect materials collected were negative for asbestos.

Inspection Date: February 3, 2021

Results and Recommendations

The results of the samples collected were negative for the presence of asbestos above 1%.
No abatement is required at this time.

It is recommended that this report accompany the 10-Day Notice of Intent for Demolition ([DEP7036Form](#)) which is to be submitted to the Kentucky Division of Air Quality prior to abatement, demolition, or renovation of any building or structure in the Commonwealth.

MRS, Inc. Analytical Laboratory Division

(502) 495-1212
Fax: (502) 491-7111

BULK SAMPLE ASBESTOS ANALYSIS

Analysis N#	# 3102098	Address:	McCracken County - 073B00080N
Client Name:	K Y T C		
Sampled By:	O'Dail Lawson		

[illegible]

Reviewed By: Wintgers Mercap
Signature

The test relates only to the items tested. This report does not represent endorsement by NVLAP or any agency of the U.S. Government. Partial Reproduction of any part of this report is strictly prohibited. Samples shall be retained for (30) days.

AJHA #1 02459

[illegible]

ENVIRONMENTAL TRAINING CONCEPTS, INC
P.O Box 99603 Louisville, KY 40269
(502)640-2951

Certification Number: ETC-AIR-031120-00387

O'Dail Lawson

has on 03-11-2020, attended and successfully completed the requirements and passed the examination with a score of 70% of better on the entitled course.

ASBESTOS INSPECTOR REFRESHER

Training was in accordance with 40 CFR Part 763 (AHERA) approved by the Commonwealth of Kentucky, the Indiana Department of Environmental Management, Tennessee Department of Environment & Conservation and The Arkansas Department of Environmental Quality. The above student received requisite training for Asbestos Accreditation under Title II of the Toxic Substance Act (TSCA).

Conducted at: 1520 Alliant Ave., Louisville, KY

Name:  Training Manager

Expiration Date: 03-11-2021

Name:  Instructor



COMMONWEALTH OF KENTUCKY
TRANSPORTATION CABINET
transportation.ky.gov

Andy Beshear
GOVERNOR

Jim Gray
SECRETARY

Asbestos Inspection Report

To: Tom Mathews

District: Central Office

Date: February 9, 2021

Conducted By: O'Dail Lawson

Report Prepared By: O'Dail Lawson

Project and Structure Identification

Project Number: CID 212952

Structure ID: McCracken 073B00081N

Structure Location: KY-1322 (Lovelaceville Road) over Middle Fork of Massac Creek

Sample Description: Any suspect materials collected were negative for asbestos.

Inspection Date: February 3, 2021

Results and Recommendations

The results of the samples collected were negative for the presence of asbestos above 1%.
No abatement is required at this time.

It is recommended that this report accompany the 10-Day Notice of Intent for Demolition ([DEP7036Form](#)) which is to be submitted to the Kentucky Division of Air Quality prior to abatement, demolition, or renovation of any building or structure in the Commonwealth.

MRS, Inc. Analytical Laboratory Division

(502) 495-1212
Fax: (502) 491-7111

Analysis N#	# 3102099	Address:	McCracken - Item # 073B00081N
Client Name:	K Y T C		
Sampled By:	O'Dail Lawson		

[illegible]

Date Analyzed : 9-Feb-21
Analyst : Winterford Mensah

Reviewed By: Winters Mena
Signature

The test relates only to the items tested. This report does not represent endorsement by NVLAP or any agency of the U.S. Government. Partial Reproduction of any part of this report is strictly prohibited. Samples shall be retained for (30) days.

AJHA #1 02459

ENVIRONMENTAL TRAINING CONCEPTS, INC
P.O Box 99603 Louisville, KY 40269
(502)640-2951

Certification Number: ETC-AIR-031120-00387

O'Dail Lawson

has on 03-11-2020, attended and successfully completed the requirements and passed the examination with a score of 70% of better on the entitled course.

ASBESTOS INSPECTOR REFRESHER

Training was in accordance with 40 CFR Part 763 (AHERA) approved by the Commonwealth of Kentucky, the Indiana Department of Environmental Management, Tennessee Department of Environment & Conservation and The Arkansas Department of Environmental Quality. The above student received requisite training for Asbestos Accreditation under Title II of the Toxic Substance Act (TSCA).

Conducted at: 1520 Alliant Ave., Louisville, KY

Name:  Training Manager

Expiration Date: 03-11-2021

Name:  Instructor

MATERIAL SUMMARY

CONTRACT ID: 212961

121GR21M003 - FD04

MB02013712101

MILBURN ROAD (KY 1371) BRIDGE 020B00040N OVER UNNAMED STREAM AT MP 06.25 BRIDGE DECK RESTORATION & WATERPROOFING.

Project Line No	Bid Code	DESCRIPTION	Quantity	Unit
0005	02562	TEMPORARY SIGNS - - 020B00040N	145.00	SQFT
0010	02650	MAINTAIN & CONTROL TRAFFIC - - 020B00040N	1.00	LS
0015	02653	LANE CLOSURE - - 020B00040N	2.00	EACH
0020	03299	ARMORED EDGE FOR CONCRETE - - 020B00040N	55.40	LF
0025	03300	ELIMINATE TRANSVERSE JOINT - - 020B00040N	60.00	LF
0030	03304	BRIDGE OVERLAY APPROACH PAVEMENT - - 020B00040N	535.00	SQYD
0035	04933	TEMP SIGNAL 2 PHASE - - 020B00040N	2.00	EACH
0040	06514	PAVE STRIPING-PERM PAINT-4 IN - - 020B00040N	600.00	LF
0045	06549	PAVE STRIPING-TEMP REM TAPE-B - - 020B00040N	1,000.00	LF
0050	06550	PAVE STRIPING-TEMP REM TAPE-W - - 020B00040N	2,000.00	LF
0055	06551	PAVE STRIPING-TEMP REM TAPE-Y - - 020B00040N	2,000.00	LF
0060	08150	STEEL REINFORCEMENT - - 020B00040N	545.00	LB
0065	08504	EPOXY SAND SLURRY - - 020B00040N	83.60	SQYD
0070	08526	CONC CLASS M FULL DEPTH PATCH - - 020B00040N	2.80	CUYD
0075	08534	CONCRETE OVERLAY-LATEX - - 020B00040N	11.00	CUYD
0080	08549	BLAST CLEANING - - 020B00040N	350.00	SQYD
0085	08551	MACHINE PREP OF SLAB - - 020B00040N	264.00	SQYD
0090	24094EC	PARTIAL DEPTH PATCHING - - 020B00040N	2.80	CUYD
0095	24692EC	DECK DRAIN RETROFIT - - 020B00040N ~ TYPE 1	12.00	EACH
0100	02569	DEMOBILIZATION	1.00	LS

MATERIAL SUMMARY

CONTRACT ID: 212961

121GR21M003 - FD04

MB03800512101

NOLAN AVENUE (US 51) BRIDGE 038B00012N OVER PURCHASE PARKWAY (JP 9003) AT MP 04.86 BRIDGE DECK RESTORATION & WATERPROOFING.

Project Line No	Bid Code	DESCRIPTION	Quantity	Unit
0105	02562	TEMPORARY SIGNS - - 038B00012N	250.00	SQFT
0110	02650	MAINTAIN & CONTROL TRAFFIC - - 038B00012N	1.00	LS
0115	03298	EXPAN JOINT REPLACE 4 IN - - 038B00012N	124.40	LF
0120	03299	ARMORED EDGE FOR CONCRETE - - 038B00012N	124.40	LF
0125	03304	BRIDGE OVERLAY APPROACH PAVEMENT - - 054B00018N	1,400.00	SQYD
0130	06514	PAVE STRIPING-PERM PAINT-4 IN - - 038B00012N	1,690.00	LF
0135	06549	PAVE STRIPING-TEMP REM TAPE-B - - 038B00012N	2,000.00	LF
0140	06550	PAVE STRIPING-TEMP REM TAPE-W - - 038B00012N	2,000.00	LF
0145	06551	PAVE STRIPING-TEMP REM TAPE-Y - - 038B00012N	2,000.00	LF
0150	08150	STEEL REINFORCEMENT - - 038B00012N	600.00	LB
0155	08504	EPOXY SAND SLURRY - - 038B00012N	150.00	SQYD
0160	08526	CONC CLASS M FULL DEPTH PATCH - - 038B00012N	14.00	CUYD
0165	08534	CONCRETE OVERLAY-LATEX - - 038B00012N	58.00	CUYD
0170	08549	BLAST CLEANING - - 038B00012N	1,541.00	SQYD
0175	08551	MACHINE PREP OF SLAB - - 038B00012N	1,392.00	SQYD
0180	24094EC	PARTIAL DEPTH PATCHING - - 038B00012N	12.00	CUYD
0185	02569	DEMOBILIZATION	1.00	LS

MATERIAL SUMMARY

CONTRACT ID: 212961

121GR21M003 - FD04

MB04203392101

FANCY FARM - LOWES ROAD (KY 862) BRIDGE 042B00132N OVER GOOSE CREEK AT MP 30.31 BRIDGE DECK RESTORATION & WATERPROOFING.

Project Line No	Bid Code	DESCRIPTION	Quantity	Unit
0190	02562	TEMPORARY SIGNS - - 042B00132N	145.00	SQFT
0195	02650	MAINTAIN & CONTROL TRAFFIC - - 042B00132N	1.00	LS
0200	02653	LANE CLOSURE - - 042B00132N	2.00	EACH
0205	03299	ARMORED EDGE FOR CONCRETE - - 042B00132N	44.00	LF
0210	03300	ELIMINATE TRANSVERSE JOINT - - 042B00132N	48.00	LF
0215	03304	BRIDGE OVERLAY APPROACH PAVEMENT - - 042B00132N	490.00	SQYD
0220	04933	TEMP SIGNAL 2 PHASE - - 042B00132N	2.00	EACH
0225	06514	PAVE STRIPING-PERM PAINT-4 IN - - 042B00132N	630.00	LF
0230	06549	PAVE STRIPING-TEMP REM TAPE-B - - 042B00132N	2,000.00	LF
0235	06550	PAVE STRIPING-TEMP REM TAPE-W - - 042B00132N	2,000.00	LF
0240	06551	PAVE STRIPING-TEMP REM TAPE-Y - - 042B00132N	2,000.00	LF
0245	08150	STEEL REINFORCEMENT - - 042B00132N	635.00	LB
0250	08504	EPOXY SAND SLURRY - - 042B00132N	97.00	SQYD
0255	08526	CONC CLASS M FULL DEPTH PATCH - - 042B00132N	2.90	CUYD
0260	08534	CONCRETE OVERLAY-LATEX - - 042B00132N	11.60	CUYD
0265	08549	BLAST CLEANING - - 042B00132N	376.00	SQYD
0270	08551	MACHINE PREP OF SLAB - - 042B00132N	279.00	SQYD
0275	24094EC	PARTIAL DEPTH PATCHING - - 042B00132N	2.90	CUYD
0280	24692EC	DECK DRAIN RETROFIT - - 042B00132N ~ TYPE 1	12.00	EACH
0285	02569	DEMOBILIZATION	1.00	LS

MATERIAL SUMMARY

CONTRACT ID: 212961

121GR21M003 - FD04

MB04208492101

FOLSOMDALE - BOAZ ROAD (KY 849) BRIDGE 042B00084N OVER MAYFIELD CREEK AT MP 10.77 BRIDGE DECK RESTORATION & WATERPROOFING.

Project Line No	Bid Code	DESCRIPTION	Quantity	Unit
0290	02562	TEMPORARY SIGNS - - 042B00084N	145.00	SQFT
0295	02650	MAINTAIN & CONTROL TRAFFIC - - 042B00084N	1.00	LS
0300	02653	LANE CLOSURE - - 042B00084N	2.00	EACH
0305	03299	ARMORED EDGE FOR CONCRETE - - 042B00084N	48.00	LF
0310	03300	ELIMINATE TRANSVERSE JOINT - - 042B00084N	104.00	LF
0315	03304	BRIDGE OVERLAY APPROACH PAVEMENT - - 042B00084N	535.00	SQYD
0320	04933	TEMP SIGNAL 2 PHASE - - 042B00084N	2.00	EACH
0325	06514	PAVE STRIPING-PERM PAINT-4 IN - - 042B00084N	950.00	LF
0330	06549	PAVE STRIPING-TEMP REM TAPE-B - - 042B00084N	2,000.00	LF
0335	06550	PAVE STRIPING-TEMP REM TAPE-W - - 042B00084N	2,000.00	LF
0340	06551	PAVE STRIPING-TEMP REM TAPE-Y - - 042B00084N	2,000.00	LF
0345	08150	STEEL REINFORCEMENT - - 042B00084N	890.00	LB
0350	08504	EPOXY SAND SLURRY - - 042B00084N	235.00	SQYD
0355	08526	CONC CLASS M FULL DEPTH PATCH - - 042B00084N	7.00	CUYD
0360	08534	CONCRETE OVERLAY-LATEX - - 042B00084N	29.40	CUYD
0365	08549	BLAST CLEANING - - 042B00084N	940.00	SQYD
0370	08551	MACHINE PREP OF SLAB - - 042B00084N	707.00	SQYD
0375	24094EC	PARTIAL DEPTH PATCHING - - 042B00084N	7.00	CUYD
0380	24692EC	DECK DRAIN RETROFIT - - 042B00084N ~ TYPE 2	30.00	EACH
0385	02569	DEMOBILIZATION	1.00	LS

MATERIAL SUMMARY

CONTRACT ID: 212961

121GR21M003 - FD04

MB05312832101

WATER VALLEY ROAD (KY 1283) BRIDGE 053B00102N OVER PURCHASE PARKWAY (JP 9003) AT MP 00.07
BRIDGE DECK RESTORATION & WATERPROOFING.

Project Line No	Bid Code	DESCRIPTION	Quantity	Unit
0390	02562	TEMPORARY SIGNS - - 053B00102N	145.00	SQFT
0395	02650	MAINTAIN & CONTROL TRAFFIC - - 053B00102N	1.00	LS
0400	02653	LANE CLOSURE - - 053B00102N	2.00	EACH
0405	03298	EXPAN JOINT REPLACE 4 IN - - 053B00102N	76.40	LF
0410	03299	ARMORED EDGE FOR CONCRETE - - 053B00102N	76.40	LF
0415	03304	BRIDGE OVERLAY APPROACH PAVEMENT - - 053B00102N	580.00	SQYD
0420	04933	TEMP SIGNAL 2 PHASE - - 053B00102N	2.00	EACH
0425	06514	PAVE STRIPING-PERM PAINT-4 IN - - 053B00102N	935.00	LF
0430	06549	PAVE STRIPING-TEMP REM TAPE-B - - 053B00102N	2,000.00	LF
0435	06550	PAVE STRIPING-TEMP REM TAPE-W - - 053B00102N	2,000.00	LF
0440	06551	PAVE STRIPING-TEMP REM TAPE-Y - - 053B00102N	2,000.00	LF
0445	08150	STEEL REINFORCEMENT - - 053B00102N	270.00	LB
0450	08504	EPOXY SAND SLURRY - - 053B00102N	197.00	SQYD
0455	08526	CONC CLASS M FULL DEPTH PATCH - - 053B00102N	8.00	CUYD
0460	08534	CONCRETE OVERLAY-LATEX - - 053B00102N	32.00	CUYD
0465	08549	BLAST CLEANING - - 053B00102N	965.00	SQYD
0470	08551	MACHINE PREP OF SLAB - - 053B00102N	768.00	SQYD
0475	24094EC	PARTIAL DEPTH PATCHING - - 053B00102N	8.00	CUYD
0480	02569	DEMOBILIZATION	1.00	LS

MATERIAL SUMMARY

CONTRACT ID: 212961

121GR21M003 - FD04

MB07226112101

PLEASANT VALLEY ROAD (KY 2611) BRIDGE 072B00029N OVER I-69 AT MP 00.10 BRIDGE DECK RESTORATION & WATERPROOFING.

Project Line No	Bid Code	DESCRIPTION	Quantity	Unit
0485	02562	TEMPORARY SIGNS - - 072B00029N	145.00	SQFT
0490	02650	MAINTAIN & CONTROL TRAFFIC - - 072B00029N	1.00	LS
0495	02653	LANE CLOSURE - - 072B00029N	2.00	EACH
0500	03298	EXPAN JOINT REPLACE 4 IN - - 072B00029N	41.80	LF
0505	03299	ARMORED EDGE FOR CONCRETE - - 072B00029N	48.10	LF
0510	03304	BRIDGE OVERLAY APPROACH PAVEMENT - - 072B00029N	535.00	SQYD
0515	04933	TEMP SIGNAL 2 PHASE - - 072B00029N	2.00	EACH
0520	06549	PAVE STRIPING-TEMP REM TAPE-B - - 072B00029N	2,000.00	LF
0525	06550	PAVE STRIPING-TEMP REM TAPE-W - - 072B00029N	2,000.00	LF
0530	06551	PAVE STRIPING-TEMP REM TAPE-Y - - 072B00029N	2,000.00	LF
0535	08150	STEEL REINFORCEMENT - - 072B00029N	270.00	LB
0540	08504	EPOXY SAND SLURRY - - 072B00029N	182.00	SQYD
0545	08526	CONC CLASS M FULL DEPTH PATCH - - 072B00029N	7.00	CUYD
0550	08534	CONCRETE OVERLAY-LATEX - - 072B00029N	27.20	CUYD
0555	08549	BLAST CLEANING - - 072B00029N	835.00	SQYD
0560	08551	MACHINE PREP OF SLAB - - 072B00029N	653.00	SQYD
0565	24094EC	PARTIAL DEPTH PATCHING - - 072B00029N	7.00	CUYD
0570	24981EC	BRIDGE CLEANING - -072B00029N	1.00	LS
0575	24982EC	CONCRETE COATING - -072B00029N	1.00	LS
0580	24983EC	BEARING LUBRICATION - - 072B00029N	8.00	EACH
0585	02569	DEMOBILIZATION	1.00	LS

MATERIAL SUMMARY

CONTRACT ID: 212961

121GR21M003 - FD04

MB07313222101

LOVELACEVILLE ROAD (KY 1322) BRIDGE 073B00081N OVER MIDDLE FORK MASSAC CREEK AT MP 03.95
BRIDGE DECK RESTORATION & WATERPROOFING.

Project Line No	Bid Code	DESCRIPTION	Quantity	Unit
0590	02562	TEMPORARY SIGNS - - 073B00081N	145.00	SQFT
0595	02650	MAINTAIN & CONTROL TRAFFIC - - 073B00081N	1.00	LS
0600	02653	LANE CLOSURE - - 073B00081N	2.00	EACH
0605	03299	ARMORED EDGE FOR CONCRETE - - 073B00081N	55.50	LF
0610	03300	ELIMINATE TRANSVERSE JOINT - - 073B00081N	60.10	LF
0615	03304	BRIDGE OVERLAY APPROACH PAVEMENT - - 073B00081N	535.00	SQYD
0620	04933	TEMP SIGNAL 2 PHASE - - 073B00081N	2.00	EACH
0625	06514	PAVE STRIPING-PERM PAINT-4 IN - - 073B00081N	300.00	LF
0630	06549	PAVE STRIPING-TEMP REM TAPE-B - - 073B00081N	2,000.00	LF
0635	06550	PAVE STRIPING-TEMP REM TAPE-W - - 073B00081N	2,000.00	LF
0640	06551	PAVE STRIPING-TEMP REM TAPE-Y - - 073B00081N	2,000.00	LF
0645	08150	STEEL REINFORCEMENT - - 073B00081N	670.00	LB
0650	08504	EPOXY SAND SLURRY - - 073B00081N	265.00	SQYD
0655	08526	CONC CLASS M FULL DEPTH PATCH - - 073B00081N	3.00	CUYD
0660	08534	CONCRETE OVERLAY-LATEX - - 073B00081N	11.00	CUYD
0665	08549	BLAST CLEANING - - 073B00081N	350.00	SQYD
0670	08551	MACHINE PREP OF SLAB - - 073B00081N	264.00	SQYD
0675	24094EC	PARTIAL DEPTH PATCHING - - 073B00081N	3.00	CUYD
0680	24692EC	DECK DRAIN RETROFIT - - 073B00081N ~ TYPE 1	4.00	EACH
0685	24692EC	DECK DRAIN RETROFIT - - 073B00081N ~ TYPE 2	6.00	EACH
0690	02569	DEMOBILIZATION	1.00	LS

MATERIAL SUMMARY

CONTRACT ID: 212961121GR21M003 - FD04MB07313222102

LOVELACEVILLE ROAD (KY 1322) BRIDGE 073B00080N OVER UNNAMED STREAM AT MP 03.80 BRIDGE DECK RESTORATION & WATERPROOFING.

Project Line No	Bid Code	DESCRIPTION	Quantity	Unit
0695	02562	TEMPORARY SIGNS - - 073B00080N	145.00	SQFT
0700	02650	MAINTAIN & CONTROL TRAFFIC - - 073B00080N	1.00	LS
0705	02653	LANE CLOSURE - - 073B00080N	2.00	EACH
0710	03299	ARMORED EDGE FOR CONCRETE - - 073B00080N	48.00	LF
0715	03300	ELIMINATE TRANSVERSE JOINT - - 073B00080N	52.00	LF
0720	03304	BRIDGE OVERLAY APPROACH PAVEMENT - - 073B00080N	535.00	SQYD
0725	04933	TEMP SIGNAL 2 PHASE - - 073B00080N	2.00	EACH
0730	06514	PAVE STRIPING-PERM PAINT-4 IN - - 073B00080N	600.00	LF
0735	06549	PAVE STRIPING-TEMP REM TAPE-B - - 073B00080N	2,000.00	LF
0740	06550	PAVE STRIPING-TEMP REM TAPE-W - - 073B00080N	2,000.00	LF
0745	06551	PAVE STRIPING-TEMP REM TAPE-Y - - 073B00080N	2,000.00	LF
0750	08150	STEEL REINFORCEMENT - - 073B00080N	670.00	LB
0755	08504	EPOXY SAND SLURRY - - 073B00080N	75.00	SQYD
0760	08526	CONC CLASS M FULL DEPTH PATCH - - 073B00080N	3.00	CUYD
0765	08534	CONCRETE OVERLAY-LATEX - - 073B00080N	9.30	CUYD
0770	08549	BLAST CLEANING - - 073B00080N	300.00	SQYD
0775	08551	MACHINE PREP OF SLAB - - 073B00080N	224.00	SQYD
0780	24094EC	PARTIAL DEPTH PATCHING - - 073B00080N	3.00	CUYD
0785	24692EC	DECK DRAIN RETROFIT - - 073B00080N ~ TYPE 1	6.00	EACH
0790	02569	DEMOBILIZATION	1.00	LS

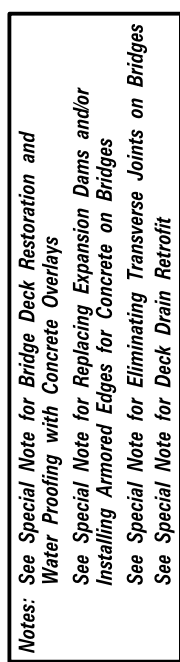

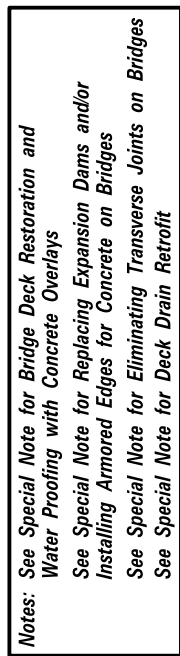

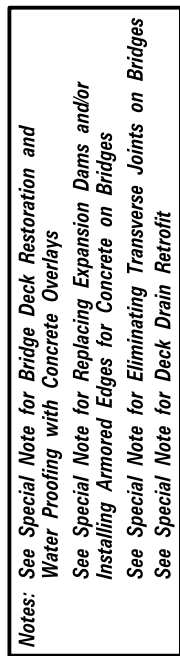



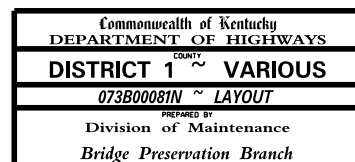

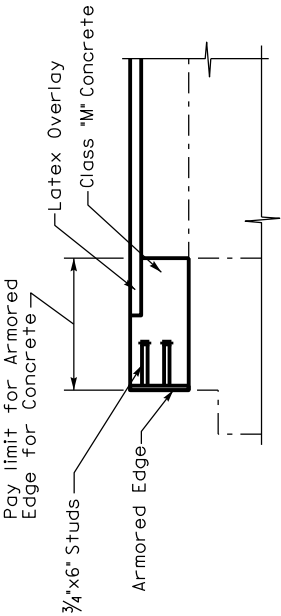

SECTION THROUGH SLAB END
Proposed

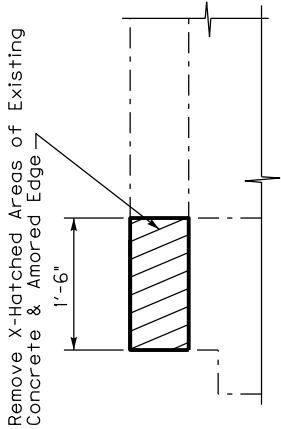

SECTION THROUGH SLAB END
Existing

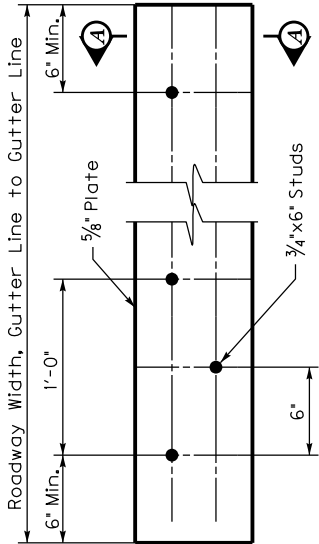

ARMORED EDGE

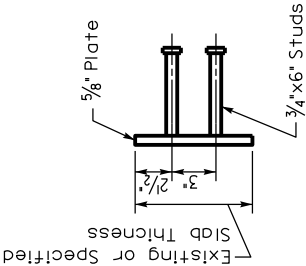

SECTION A-A

BRIDGE NO.
020B00040N
042B00084N
042B00132N
073B00080N
073B00081N

Note: See Special Note for Replacing Expansion Dams and/or Installing Armored Edges for Concrete on Bridges

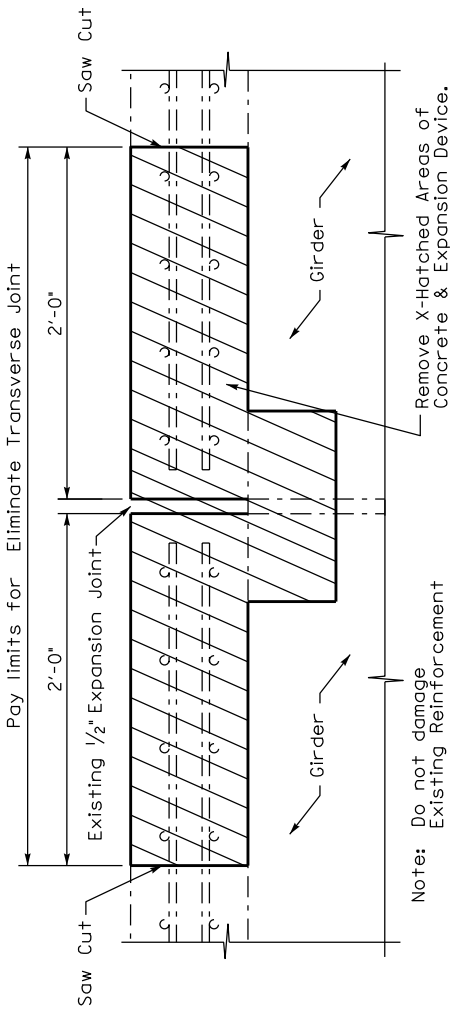

SECTION THROUGH JOINT
(Existing)

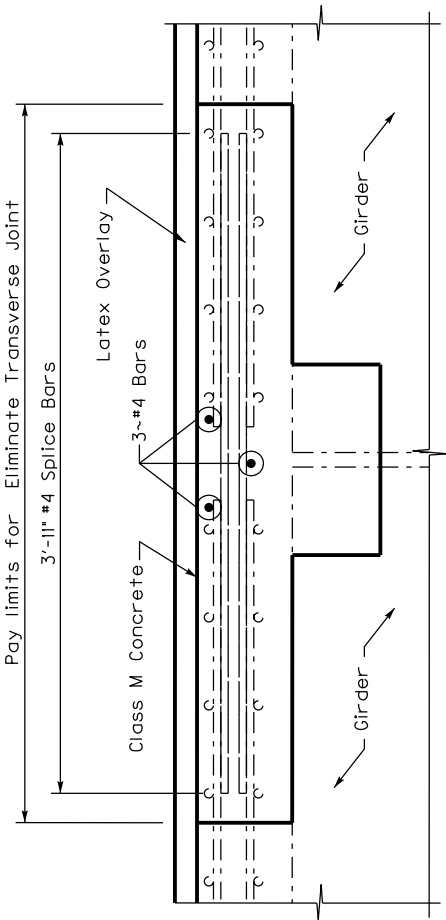

SECTION THROUGH JOINT
(Proposed)

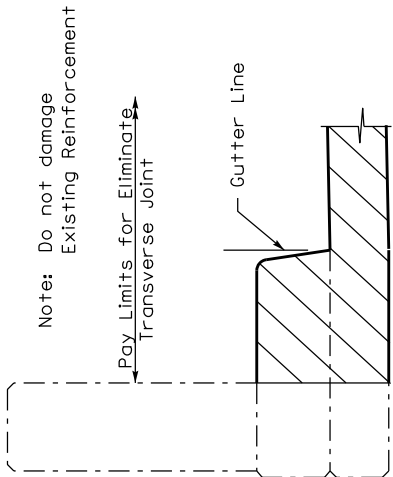

SECTION THROUGH PAPAPET
(Existing)

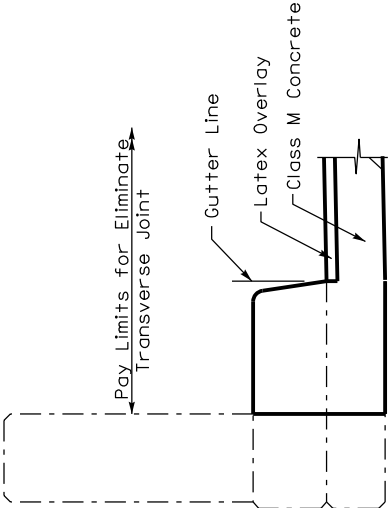

SECTION THROUGH PAPAPET
(Proposed)

BRIDGE NO.
020B00040N
042B00084N
042B00132N
073B00080N
073B00081N

Note: See Special Note for Eliminating Transverse Joints on Bridges

Commonwealth of Kentucky	
DEPARTMENT OF HIGHWAYS	
DISTRICT 1	COUNTY ~ VARIOUS
ELIMINATE TRANSVERSE JOINT	
PREPARED BY	
Division of Maintenance	
Bridge Preservation Branch	

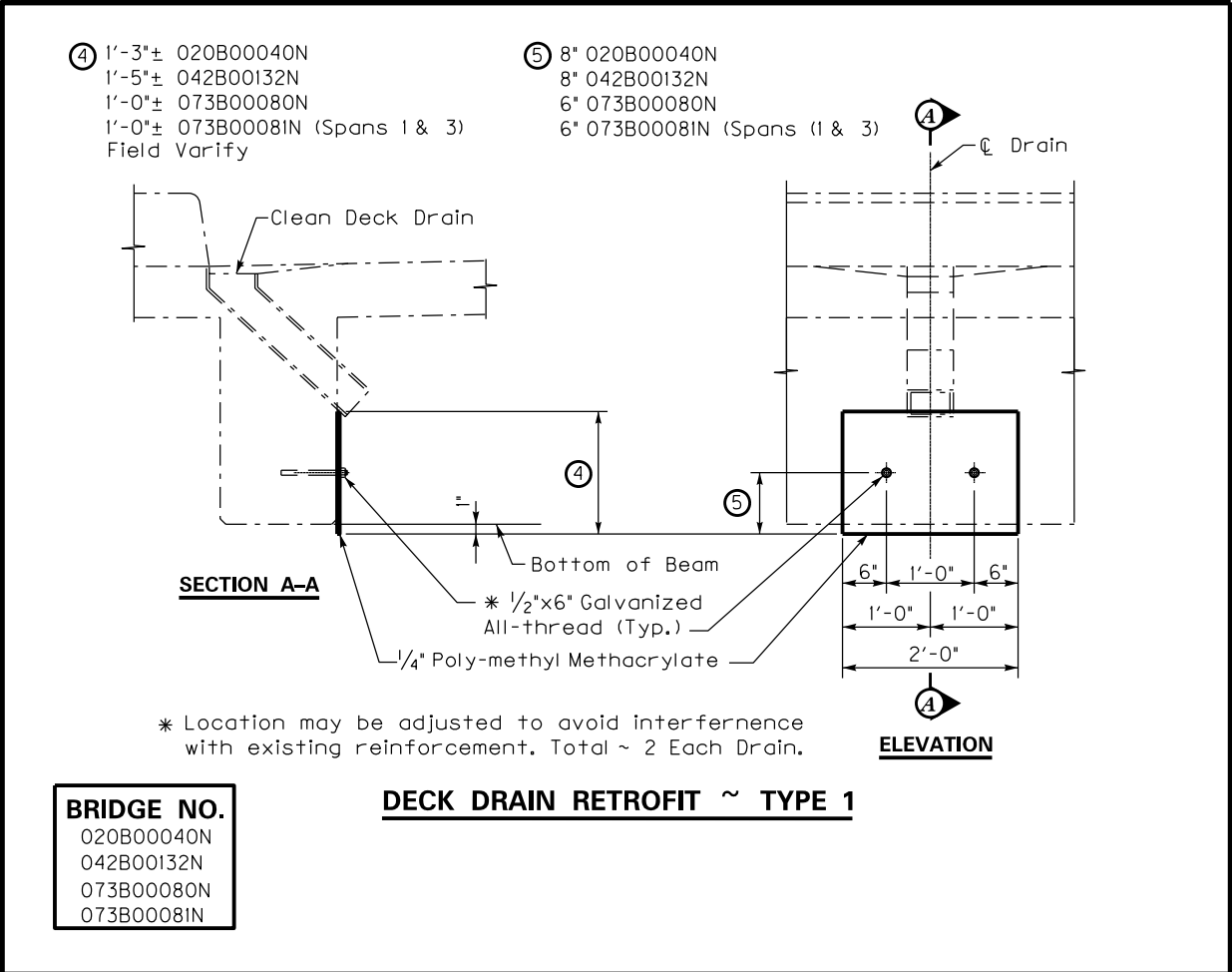

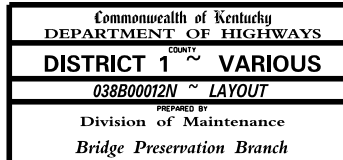

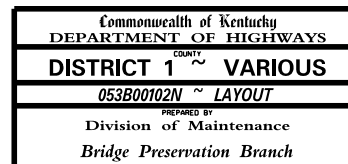

Note: Remove X-Hatched Areas of Existing Concrete & Expansion Device.

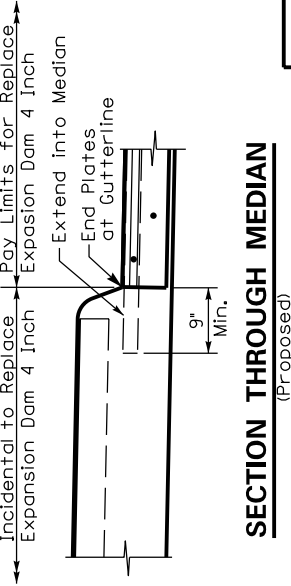
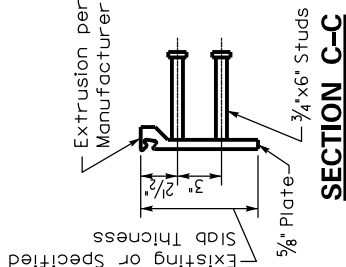
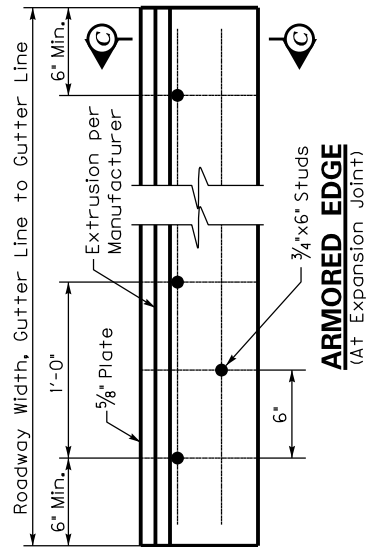
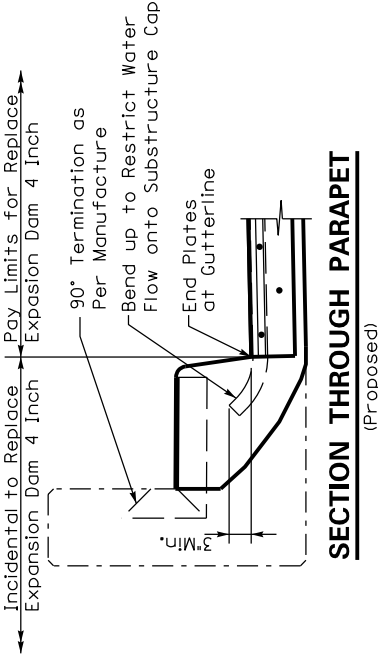
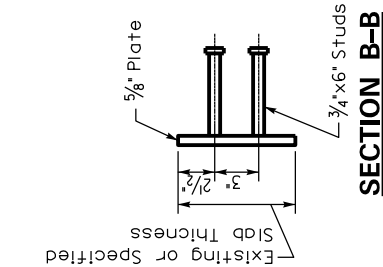
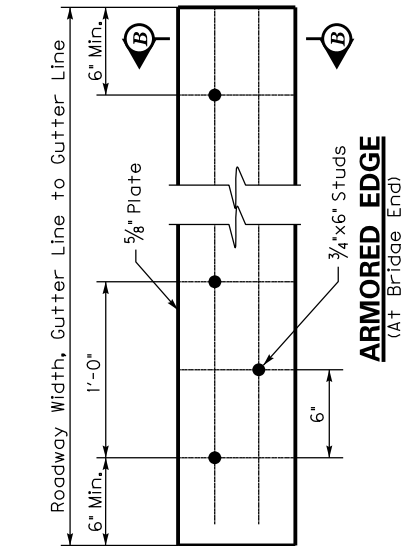
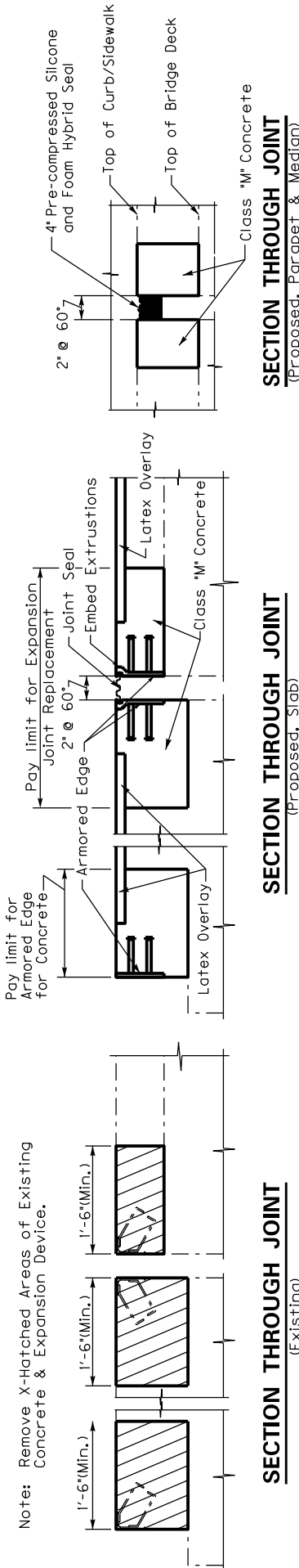

Commonwealth of Kentucky
DEPARTMENT OF HIGHWAYS
DISTRICT 1 ~ VARIOUS
EXPANSION DAM REPLACE 4"
PREPARED BY
Division of Maintenance
Bridge Preservation Branch

BRIDGE NO.
038B00012N
053B00102N

Note: See Special Note for Replacing Expansion Dams and/or Installing Armored Edges for Concrete on Bridges



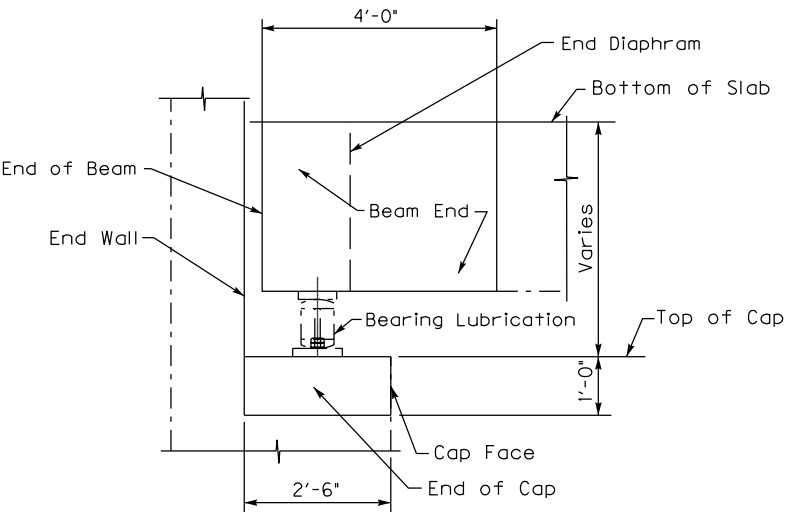

Front Face of End Wall, Top and Face of Cap the Entire Length of Cap including Cap Ends, Beam Ends and End Diaphragms shall have debris removed pressure washed and have concrete coating applied as specified within the limits shown.

SECTION THROUGH ABUTMENT AND BEAM END

**BRIDGE CLEANING AND
PREVENTIVE MAINTENANCE**

BRIDGE NO.
072B00029N

*Note: See Special Note for Bridge Cleaning
and Preventive Maintenance*

Commonwealth of Kentucky	
DEPARTMENT OF HIGHWAYS	
DISTRICT 1	COUNTY ~ VARIOUS
072B000029N ~ PREVENTIVE MAINTENANCE	
PREPARED BY	
Division of Maintenance	
Bridge Preservation Branch	

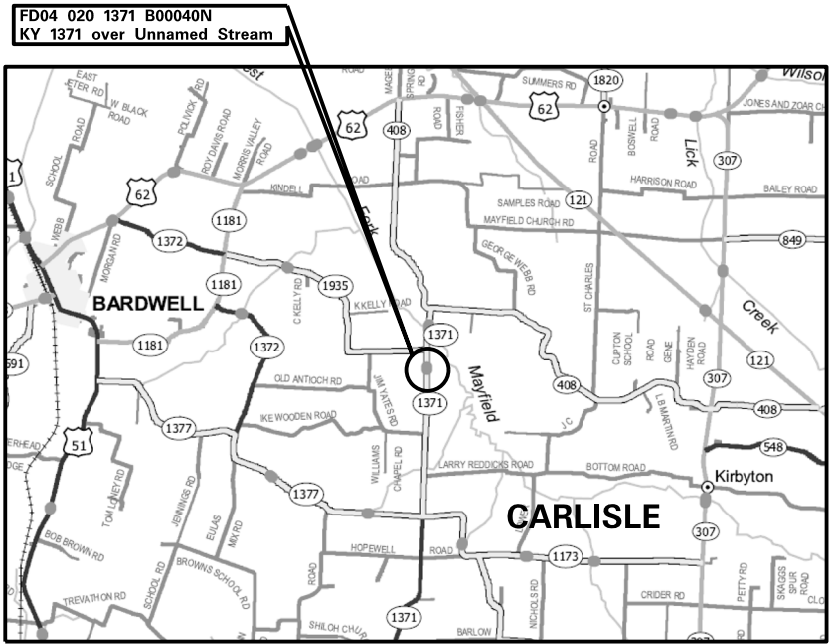

LOCATION MAP ~ CARLISLE COUNTY

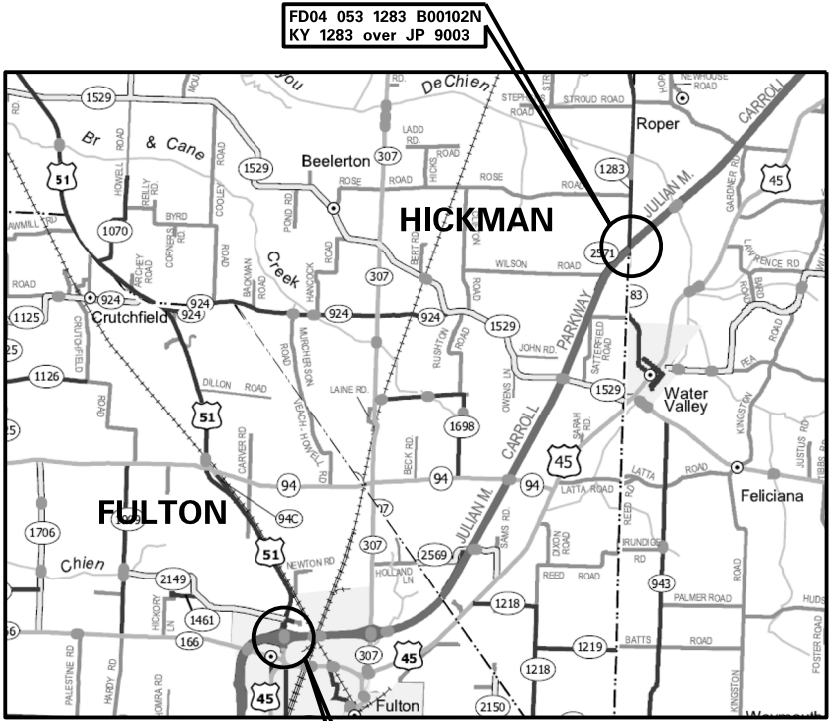

LOCATION MAP ~ FULTON-HICKMAN COUNTIES

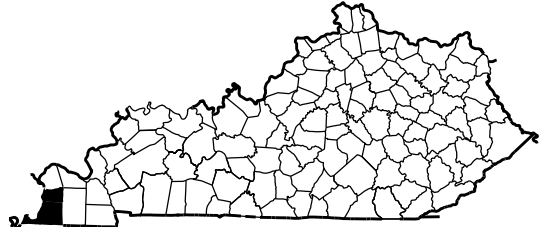

Commonwealth of Kentucky	
DEPARTMENT OF HIGHWAYS	
DISTRICT 1	COUNTY ~ VARIOUS
LOCATION MAP	
PREPARED BY	
Division of Maintenance	
Bridge Preservation Branch	

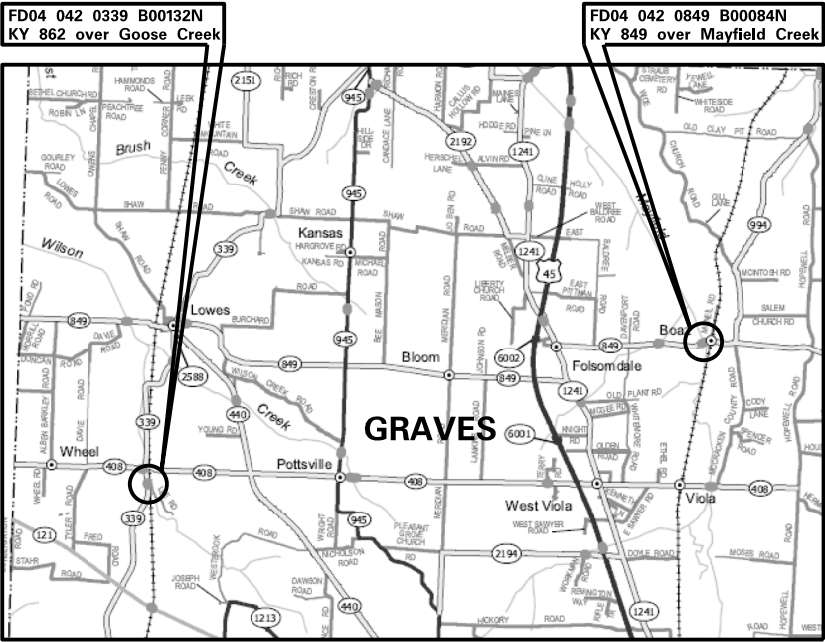

LOCATION MAP ~ GRAVES COUNTY

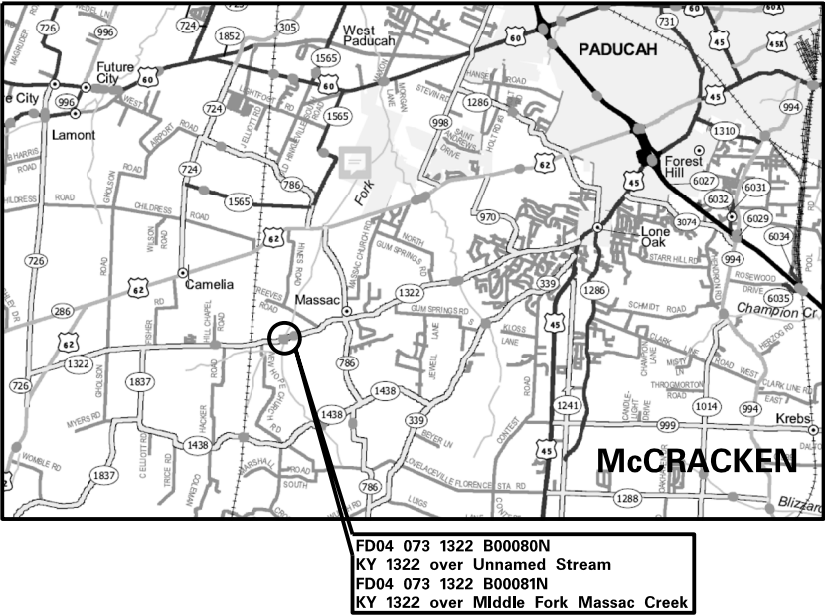

LOCATION MAP ~ MCCRACKEN COUNTY

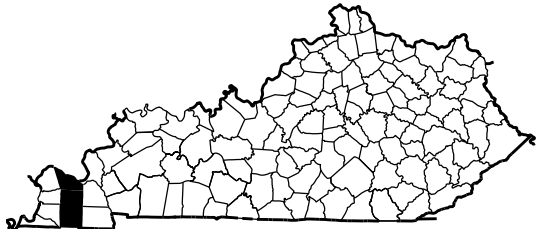

Commonwealth of Kentucky	
DEPARTMENT OF HIGHWAYS	
DISTRICT 1	COUNTY ~ VARIOUS
LOCATION MAP	
PREPARED BY	
Division of Maintenance	
Bridge Preservation Branch	

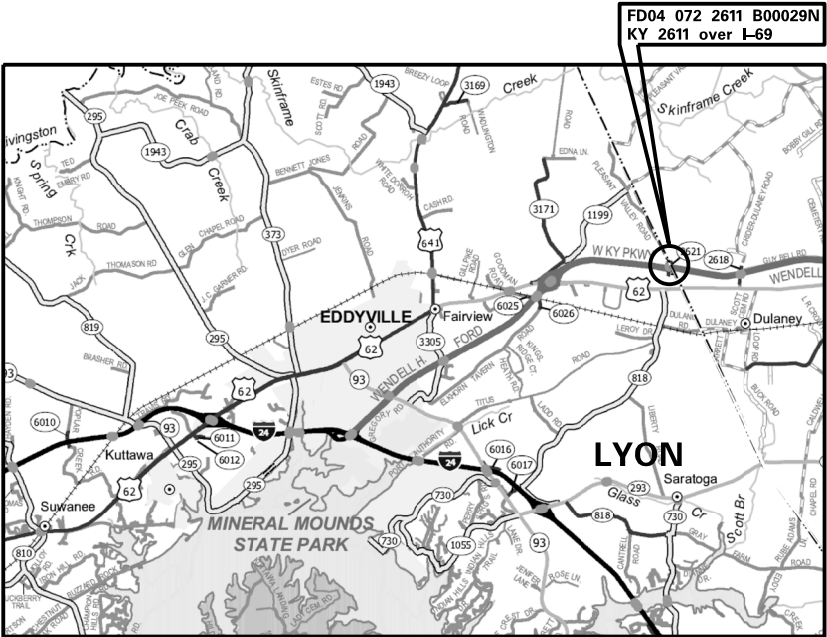

LOCATION MAP ~ LYON COUNTY

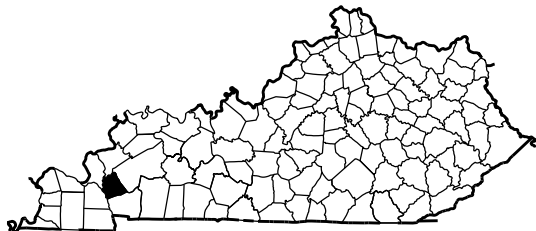

Commonwealth of Kentucky	
DEPARTMENT OF HIGHWAYS	
DISTRICT 1	COUNTY ~ VARIOUS
LOCATION MAP	
PREPARED BY	
Division of Maintenance	
Bridge Preservation Branch	

PART II

SPECIFICATIONS AND STANDARD DRAWINGS

SPECIFICATIONS REFERENCE

Any reference in the plans or proposal to previous editions of the *Standard Specifications for Road and Bridge Construction* and *Standard Drawings* are superseded by *Standard Specifications for Road and Bridge Construction, Edition of 2019* and *Standard Drawings, Edition of 2020*.

SUPPLEMENTAL SPECIFICATIONS

The contractor shall use the Supplemental Specifications that are effective at the time of letting.
The Supplemental Specifications can be found at the following link:

<http://transportation.ky.gov/Construction/Pages/Kentucky-Standard-Specifications.aspx>

STANDARD DRAWINGS THAT APPLY

TRAFFIC
~ *TEMPORARY* ~
TRAFFIC CONTROL

LANE CLOSURE TWO LANE HIGHWAY	TTC-110 C.E.
LANE CLOSURE USING TRAFFIC SIGNALS	TTC-115 C.E.

BRIDGES
MISELLANEOUS STANDARDS

BRIDGE RESTORATION AND WATERPROFING	
WITH CONCRETE OVERLAYS	BGX-009 C.E.
AMORED EDGES	BJE-001 C.E.
EXPANSION JOINT REPLACEMENT 4” & 5”	BJE-006 C.E.

PART III

EMPLOYMENT, WAGE AND RECORD REQUIREMENTS

**TRANSPORTATION CABINET
DEPARTMENT OF HIGHWAYS**

**LABOR AND WAGE REQUIREMENTS
APPLICABLE TO OTHER THAN FEDERAL-AID SYSTEM PROJECTS**

- I. Application
- II. Nondiscrimination of Employees (KRS 344)

I. APPLICATION

1. These contract provisions shall apply to all work performed on the contract by the contractor with his own organization and with the assistance of workmen under his immediate superintendence and to all work performed on the contract by piecework, station work or by subcontract. The contractor's organization shall be construed to include only workmen employed and paid directly by the contractor and equipment owned or rented by him, with or without operators.

2. The contractor shall insert in each of his subcontracts all of the stipulations contained in these Required Provisions and such other stipulations as may be required.

3. A breach of any of the stipulations contained in these Required Provisions may be grounds for termination of the contract.

3. If the contractor is in control of apprenticeship or other training or retraining, including on-the-job training programs, he shall not discriminate against an individual because of his race, color, religion, national origin, sex, disability or age forty (40) and over, in admission to, or employment in any program established to provide apprenticeship or other training.

4. The contractor will send to each labor union or representative of workers with which he has a collective bargaining agreement or other contract or understanding, a notice to be provided advising the said labor union or workers' representative of the contractor's commitments under this section, and shall post copies of the notice in conspicuous places available to employees and applicants for employment. The contractor will take such action with respect to any subcontract or purchase order as the administering agency may direct as a means of enforcing such provisions, including sanctions for non-compliance.

Revised: January 25, 2017

II. NONDISCRIMINATION OF EMPLOYEES

**AN ACT OF THE KENTUCKY
GENERAL ASSEMBLY TO PREVENT
DISCRIMINATION IN EMPLOYMENT
KRS CHAPTER 344
EFFECTIVE JUNE 16, 1972**

The contract on this project, in accordance with KRS Chapter 344, provides that during the performance of this contract, the contractor agrees as follows:

1. The contractor shall not fail or refuse to hire, or shall not discharge any individual, or otherwise discriminate against an individual with respect to his compensation, terms, conditions, or privileges of employment, because of such individual's race, color, religion, national origin, sex, disability or age (forty and above); or limit, segregate, or classify his employees in any way which would deprive or tend to deprive an individual of employment opportunities or otherwise adversely affect his status as an employee, because of such individual's race, color, religion, national origin, sex, disability or age forty (40) and over. The contractor agrees to post in conspicuous places, available to employees and applicants for employment, notices to be provided setting forth the provisions of this nondiscrimination clause.

2. The contractor shall not print or publish or cause to be printed or published a notice or advertisement relating to employment by such an employer or membership in or any classification or referral for employment by the employment agency, indicating any preference, limitation, specification, or discrimination, based on race, color, religion, national origin, sex, or age forty (40) and over, or because the person is a qualified individual with a disability, except that such a notice or advertisement may indicate a preference, limitation, or specification based on religion, national origin, sex, or age forty (40) and over, or because the person is a qualified individual with a disability, when religion, national origin, sex, or age forty (40) and over, or because the person is a qualified individual with a disability, is a bona fide occupational qualification for employment.

EXECUTIVE BRANCH CODE OF ETHICS

In the 1992 regular legislative session, the General Assembly passed and Governor Brereton Jones signed Senate Bill 63 (codified as KRS 11A), the Executive Branch Code of Ethics, which states, in part:

KRS 11A.040 (7) provides:

No present or former public servant shall, within six (6) months following termination of his office or employment, accept employment, compensation, or other economic benefit from any person or business that contracts or does business with, or is regulated by, the state in matters in which he was directly involved during the last thirty-six (36) months of his tenure. This provision shall not prohibit an individual from returning to the same business, firm, occupation, or profession in which he was involved prior to taking office or beginning his term of employment, or for which he received, prior to his state employment, a professional degree or license, provided that, for a period of six (6) months, he personally refrains from working on any matter in which he was directly involved during the last thirty-six (36) months of his tenure in state government. This subsection shall not prohibit the performance of ministerial functions, including but not limited to filing tax returns, filing applications for permits or licenses, or filing incorporation papers, nor shall it prohibit the former officer or public servant from receiving public funds disbursed through entitlement programs.

KRS 11A.040 (9) states:

A former public servant shall not represent a person or business before a state agency in a matter in which the former public servant was directly involved during the last thirty-six (36) months of his tenure, for a period of one (1) year after the latter of:

- a) The date of leaving office or termination of employment; or
- b) The date the term of office expires to which the public servant was elected.

This law is intended to promote public confidence in the integrity of state government and to declare as public policy the idea that state employees should view their work as a public trust and not as a way to obtain private benefits.

If you have worked for the executive branch of state government within the past six months, you may be subject to the law's prohibitions. The law's applicability may be different if you hold elected office or are contemplating representation of another before a state agency.

Also, if you are affiliated with a firm which does business with the state and which employs former state executive-branch employees, you should be aware that the law may apply to them.

In case of doubt, the law permits you to request an advisory opinion from the Executive Branch Ethics Commission, 3 Fountain Place, Frankfort, Kentucky 40601; telephone (502) 564-7954.

Revised: January 27, 2017

Kentucky Equal Employment Opportunity Act of 1978

The requirements of the Kentucky Equal Employment Opportunity Act of 1978 (KRS 45.560-45.640) shall apply to this Contract. The apparent low Bidder will be required to submit EEO forms to the Division of Construction Procurement, which will then forward to the Finance and Administration Cabinet for review and approval. No award will become effective until all forms are submitted and EEO/CC has certified compliance. The required EEO forms are as follows:

- EEO-1: Employer Information Report
- Affidavit of Intent to Comply
- Employee Data Sheet
- Subcontractor Report

These forms are available on the Finance and Administration's web page under ***Vendor Information, Standard Attachments and General Terms*** at the following address:
<https://www.eProcurement.ky.gov>.

Bidders currently certified as being in compliance by the Finance and Administration Cabinet may submit a copy of their approval letter in lieu of the referenced EEO forms.

For questions or assistance please contact the Finance and Administration Cabinet by email at **finance.contractcompliance@ky.gov** or by phone at 502-564-2874.

EMPLOYEE RIGHTS UNDER THE FAIR LABOR STANDARDS ACT

THE UNITED STATES DEPARTMENT OF LABOR WAGE AND HOUR DIVISION

FEDERAL MINIMUM WAGE

\$7.25

 PER HOUR

BEGINNING JULY 24, 2009

OVERTIME PAY

At least $1\frac{1}{2}$ times your regular rate of pay for all hours worked over 40 in a workweek.

CHILD LABOR

An employee must be at least **16** years old to work in most non-farm jobs and at least **18** to work in non-farm jobs declared hazardous by the Secretary of Labor.

Youths **14** and **15** years old may work outside school hours in various non-manufacturing, non-mining, non-hazardous jobs under the following conditions:

No more than

- **3** hours on a school day or **18** hours in a school week;
- **8** hours on a non-school day or **40** hours in a non-school week.

Also, work may not begin before **7 a.m.** or end after **7 p.m.**, except from June 1 through Labor Day, when evening hours are extended to **9 p.m.** Different rules apply in agricultural employment.

TIP CREDIT

Employers of "tipped employees" must pay a cash wage of at least \$2.13 per hour if they claim a tip credit against their minimum wage obligation. If an employee's tips combined with the employer's cash wage of at least \$2.13 per hour do not equal the minimum hourly wage, the employer must make up the difference. Certain other conditions must also be met.

ENFORCEMENT

The Department of Labor may recover back wages either administratively or through court action, for the employees that have been underpaid in violation of the law. Violations may result in civil or criminal action.

Employers may be assessed civil money penalties of up to \$1,100 for each willful or repeated violation of the minimum wage or overtime pay provisions of the law and up to \$11,000 for each employee who is the subject of a violation of the Act's child labor provisions. In addition, a civil money penalty of up to \$50,000 may be assessed for each child labor violation that causes the death or serious injury of any minor employee, and such assessments may be doubled, up to \$100,000, when the violations are determined to be willful or repeated. The law also prohibits discriminating against or discharging workers who file a complaint or participate in any proceeding under the Act.

ADDITIONAL INFORMATION

- Certain occupations and establishments are exempt from the minimum wage and/or overtime pay provisions.
- Special provisions apply to workers in American Samoa and the Commonwealth of the Northern Mariana Islands.
- Some state laws provide greater employee protections; employers must comply with both.
- The law requires employers to display this poster where employees can readily see it.
- Employees under 20 years of age may be paid \$4.25 per hour during their first 90 consecutive calendar days of employment with an employer.
- Certain full-time students, student learners, apprentices, and workers with disabilities may be paid less than the minimum wage under special certificates issued by the Department of Labor.

For additional information:



1-866-4-USWAGE

(1-866-487-9243)

TTY: 1-877-889-5627



WWW.WAGEHOUR.DOL.GOV

PART IV

INSURANCE

Refer to
Kentucky Standard Specifications for Road and Bridge Construction,
current edition

PART V

BID ITEMS

212961

PROPOSAL BID ITEMS

Report Date 2/16/21

Page 1 of 7

Section: 0001 - BRIDGES

LINE	BID CODE	ALT	DESCRIPTION	QUANTITY	UNIT	UNIT PRIC	FP	AMOUNT
0010	02562		TEMPORARY SIGNS - 020B00040N	145.00	SQFT		\$	
0020	02650		MAINTAIN & CONTROL TRAFFIC - 020B00040N	1.00	LS		\$	
0030	02653		LANE CLOSURE - 020B00040N	2.00	EACH		\$	
0040	03299		ARMORED EDGE FOR CONCRETE - 020B00040N	55.40	LF		\$	
0050	03300		ELIMINATE TRANSVERSE JOINT - 020B00040N	60.00	LF		\$	
0060	03304		BRIDGE OVERLAY APPROACH PAVEMENT - 020B00040N	535.00	SQYD		\$	
0070	04933		TEMP SIGNAL 2 PHASE - 020B00040N	2.00	EACH		\$	
0080	06514		PAVE STRIPING-PERM PAINT-4 IN - 020B00040N	600.00	LF		\$	
0090	06549		PAVE STRIPING-TEMP REM TAPE-B - 020B00040N	1,000.00	LF		\$	
0100	06550		PAVE STRIPING-TEMP REM TAPE-W - 020B00040N	2,000.00	LF		\$	
0110	06551		PAVE STRIPING-TEMP REM TAPE-Y - 020B00040N	2,000.00	LF		\$	
0120	08150		STEEL REINFORCEMENT - 020B00040N	545.00	LB		\$	
0130	08504		EPOXY SAND SLURRY - 020B00040N	83.60	SQYD		\$	
0140	08526		CONC CLASS M FULL DEPTH PATCH - 020B00040N	2.80	CUYD		\$	
0150	08534		CONCRETE OVERLAY-LATEX - 020B00040N	11.00	CUYD		\$	
0160	08549		BLAST CLEANING - 020B00040N	350.00	SQYD		\$	
0170	08551		MACHINE PREP OF SLAB - 020B00040N	264.00	SQYD		\$	
0180	24094EC		PARTIAL DEPTH PATCHING - 020B00040N	2.80	CUYD		\$	
0190	24692EC		DECK DRAIN RETROFIT - 020B00040N ~ TYPE 1	12.00	EACH		\$	

Section: 0002 - BRIDGES

LINE	BID CODE	ALT	DESCRIPTION	QUANTITY	UNIT	UNIT PRIC	FP	AMOUNT
0200	02562		TEMPORARY SIGNS - 038B00012N	250.00	SQFT		\$	
0210	02650		MAINTAIN & CONTROL TRAFFIC - 038B00012N	1.00	LS		\$	
0220	03298		EXPAN JOINT REPLACE 4 IN - 038B00012N	124.40	LF		\$	
0230	03299		ARMORED EDGE FOR CONCRETE - 038B00012N	124.40	LF		\$	

212961

PROPOSAL BID ITEMS

Page 2 of 7

Report Date 2/16/21

LINE	BID CODE	ALT	DESCRIPTION	QUANTITY	UNIT	UNIT PRIC	FP	AMOUNT
0240	03304		BRIDGE OVERLAY APPROACH PAVEMENT - 054B00018N	1,400.00	SQYD		\$	
0250	06514		PAVE STRIPING-PERM PAINT-4 IN - 038B00012N	1,690.00	LF		\$	
0260	06549		PAVE STRIPING-TEMP REM TAPE-B - 038B00012N	2,000.00	LF		\$	
0270	06550		PAVE STRIPING-TEMP REM TAPE-W - 038B00012N	2,000.00	LF		\$	
0280	06551		PAVE STRIPING-TEMP REM TAPE-Y - 038B00012N	2,000.00	LF		\$	
0290	08150		STEEL REINFORCEMENT - 038B00012N	600.00	LB		\$	
0300	08504		EPOXY SAND SLURRY - 038B00012N	150.00	SQYD		\$	
0310	08526		CONC CLASS M FULL DEPTH PATCH - 038B00012N	14.00	CUYD		\$	
0320	08534		CONCRETE OVERLAY-LATEX - 038B00012N	58.00	CUYD		\$	
0330	08549		BLAST CLEANING - 038B00012N	1,541.00	SQYD		\$	
0340	08551		MACHINE PREP OF SLAB - 038B00012N	1,392.00	SQYD		\$	
0350	24094EC		PARTIAL DEPTH PATCHING - 038B00012N	12.00	CUYD		\$	

Section: 0003 - BRIDGES

LINE	BID CODE	ALT	DESCRIPTION	QUANTITY	UNIT	UNIT PRIC	FP	AMOUNT
0360	02562		TEMPORARY SIGNS - 042B00132N	145.00	SQFT		\$	
0370	02650		MAINTAIN & CONTROL TRAFFIC - 042B00132N	1.00	LS		\$	
0380	02653		LANE CLOSURE - 042B00132N	2.00	EACH		\$	
0390	03299		ARMORED EDGE FOR CONCRETE - 042B00132N	44.00	LF		\$	
0400	03300		ELIMINATE TRANSVERSE JOINT - 042B00132N	48.00	LF		\$	
0410	03304		BRIDGE OVERLAY APPROACH PAVEMENT - 042B00132N	490.00	SQYD		\$	
0420	04933		TEMP SIGNAL 2 PHASE - 042B00132N	2.00	EACH		\$	
0430	06514		PAVE STRIPING-PERM PAINT-4 IN - 042B00132N	630.00	LF		\$	
0440	06549		PAVE STRIPING-TEMP REM TAPE-B - 042B00132N	2,000.00	LF		\$	
0450	06550		PAVE STRIPING-TEMP REM TAPE-W - 042B00132N	2,000.00	LF		\$	
0460	06551		PAVE STRIPING-TEMP REM TAPE-Y - 042B00132N	2,000.00	LF		\$	
0470	08150		STEEL REINFORCEMENT - 042B00132N	635.00	LB		\$	
0480	08504		EPOXY SAND SLURRY - 042B00132N	97.00	SQYD		\$	

Report Date 2/16/21

LINE	BID CODE	ALT	DESCRIPTION	QUANTITY	UNIT	UNIT PRIC	FP	AMOUNT
0490	08526		CONC CLASS M FULL DEPTH PATCH - 042B00132N	2.90	CUYD		\$	
0500	08534		CONCRETE OVERLAY-LATEX - 042B00132N	11.60	CUYD		\$	
0510	08549		BLAST CLEANING - 042B00132N	376.00	SQYD		\$	
0520	08551		MACHINE PREP OF SLAB - 042B00132N	279.00	SQYD		\$	
0530	24094EC		PARTIAL DEPTH PATCHING - 042B00132N	2.90	CUYD		\$	
0540	24692EC		DECK DRAIN RETROFIT - 042B00132N ~ TYPE 1	12.00	EACH		\$	

Section: 0004 - BRIDGES

LINE	BID CODE	ALT	DESCRIPTION	QUANTITY	UNIT	UNIT PRIC	FP	AMOUNT
0550	02562		TEMPORARY SIGNS - 042B00084N	145.00	SQFT		\$	
0560	02650		MAINTAIN & CONTROL TRAFFIC - 042B00084N	1.00	LS		\$	
0570	02653		LANE CLOSURE - 042B00084N	2.00	EACH		\$	
0580	03299		ARMORED EDGE FOR CONCRETE - 042B00084N	48.00	LF		\$	
0590	03300		ELIMINATE TRANSVERSE JOINT - 042B00084N	104.00	LF		\$	
0600	03304		BRIDGE OVERLAY APPROACH PAVEMENT - 042B00084N	535.00	SQYD		\$	
0610	04933		TEMP SIGNAL 2 PHASE - 042B00084N	2.00	EACH		\$	
0620	06514		PAVE STRIPING-PERM PAINT-4 IN - 042B00084N	950.00	LF		\$	
0630	06549		PAVE STRIPING-TEMP REM TAPE-B - 042B00084N	2,000.00	LF		\$	
0640	06550		PAVE STRIPING-TEMP REM TAPE-W - 042B00084N	2,000.00	LF		\$	
0650	06551		PAVE STRIPING-TEMP REM TAPE-Y - 042B00084N	2,000.00	LF		\$	
0660	08150		STEEL REINFORCEMENT - 042B00084N	890.00	LB		\$	
0670	08504		EPOXY SAND SLURRY - 042B00084N	235.00	SQYD		\$	
0680	08526		CONC CLASS M FULL DEPTH PATCH - 042B00084N	7.00	CUYD		\$	
0690	08534		CONCRETE OVERLAY-LATEX - 042B00084N	29.40	CUYD		\$	
0700	08549		BLAST CLEANING - 042B00084N	940.00	SQYD		\$	
0710	08551		MACHINE PREP OF SLAB - 042B00084N	707.00	SQYD		\$	
0720	24094EC		PARTIAL DEPTH PATCHING - 042B00084N	7.00	CUYD		\$	

LINE	BID CODE	ALT	DESCRIPTION	QUANTITY	UNIT	UNIT PRIC	FP	AMOUNT
0730	24692EC		DECK DRAIN RETROFIT - 042B00084N ~ TYPE 2	30.00	EACH		\$	

Section: 0005 - BRIDGES

LINE	BID CODE	ALT	DESCRIPTION	QUANTITY	UNIT	UNIT PRIC	FP	AMOUNT
0740	02562		TEMPORARY SIGNS - 053B00102N	145.00	SQFT		\$	
0750	02650		MAINTAIN & CONTROL TRAFFIC - 053B00102N	1.00	LS		\$	
0760	02653		LANE CLOSURE - 053B00102N	2.00	EACH		\$	
0770	03298		EXPAN JOINT REPLACE 4 IN - 053B00102N	76.40	LF		\$	
0780	03299		ARMORED EDGE FOR CONCRETE - 053B00102N	76.40	LF		\$	
0790	03304		BRIDGE OVERLAY APPROACH PAVEMENT - 053B00102N	580.00	SQYD		\$	
0800	04933		TEMP SIGNAL 2 PHASE - 053B00102N	2.00	EACH		\$	
0810	06514		PAVE STRIPING-PERM PAINT-4 IN - 053B00102N	935.00	LF		\$	
0820	06549		PAVE STRIPING-TEMP REM TAPE-B - 053B00102N	2,000.00	LF		\$	
0830	06550		PAVE STRIPING-TEMP REM TAPE-W - 053B00102N	2,000.00	LF		\$	
0840	06551		PAVE STRIPING-TEMP REM TAPE-Y - 053B00102N	2,000.00	LF		\$	
0850	08150		STEEL REINFORCEMENT - 053B00102N	270.00	LB		\$	
0860	08504		EPOXY SAND SLURRY - 053B00102N	197.00	SQYD		\$	
0870	08526		CONC CLASS M FULL DEPTH PATCH - 053B00102N	8.00	CUYD		\$	
0880	08534		CONCRETE OVERLAY-LATEX - 053B00102N	32.00	CUYD		\$	
0890	08549		BLAST CLEANING - 053B00102N	965.00	SQYD		\$	
0900	08551		MACHINE PREP OF SLAB - 053B00102N	768.00	SQYD		\$	
0910	24094EC		PARTIAL DEPTH PATCHING - 053B00102N	8.00	CUYD		\$	

Section: 0006 - BRIDGES

LINE	BID CODE	ALT	DESCRIPTION	QUANTITY	UNIT	UNIT PRIC	FP	AMOUNT
0920	02562		TEMPORARY SIGNS - 072B00029N	145.00	SQFT		\$	
0930	02650		MAINTAIN & CONTROL TRAFFIC - 072B00029N	1.00	LS		\$	
0940	02653		LANE CLOSURE - 072B00029N	2.00	EACH		\$	

LINE	BID CODE	ALT	DESCRIPTION	QUANTITY	UNIT	UNIT PRIC	FP	AMOUNT
0950	03298		EXPAN JOINT REPLACE 4 IN - 072B00029N	41.80	LF		\$	
0960	03299		ARMORED EDGE FOR CONCRETE - 072B00029N	48.10	LF		\$	
0970	03304		BRIDGE OVERLAY APPROACH PAVEMENT - 072B00029N	535.00	SQYD		\$	
0980	04933		TEMP SIGNAL 2 PHASE - 072B00029N	2.00	EACH		\$	
0990	06549		PAVE STRIPING-TEMP REM TAPE-B - 072B00029N	2,000.00	LF		\$	
1000	06550		PAVE STRIPING-TEMP REM TAPE-W - 072B00029N	2,000.00	LF		\$	
1010	06551		PAVE STRIPING-TEMP REM TAPE-Y - 072B00029N	2,000.00	LF		\$	
1020	08150		STEEL REINFORCEMENT - 072B00029N	270.00	LB		\$	
1030	08504		EPOXY SAND SLURRY - 072B00029N	182.00	SQYD		\$	
1040	08526		CONC CLASS M FULL DEPTH PATCH - 072B00029N	7.00	CUYD		\$	
1050	08534		CONCRETE OVERLAY-LATEX - 072B00029N	27.20	CUYD		\$	
1060	08549		BLAST CLEANING - 072B00029N	835.00	SQYD		\$	
1070	08551		MACHINE PREP OF SLAB - 072B00029N	653.00	SQYD		\$	
1080	24094EC		PARTIAL DEPTH PATCHING - 072B00029N	7.00	CUYD		\$	
1090	24981EC		BRIDGE CLEANING -072B00029N	1.00	LS		\$	
1100	24982EC		CONCRETE COATING -072B00029N	1.00	LS		\$	
1110	24983EC		BEARING LUBRICATION - 072B00029N	8.00	EACH		\$	

Section: 0007 - BRIDGES

LINE	BID CODE	ALT	DESCRIPTION	QUANTITY	UNIT	UNIT PRIC	FP	AMOUNT
1120	02562		TEMPORARY SIGNS - 073B00081N	145.00	SQFT		\$	
1130	02650		MAINTAIN & CONTROL TRAFFIC - 073B00081N	1.00	LS		\$	
1140	02653		LANE CLOSURE - 073B00081N	2.00	EACH		\$	
1150	03299		ARMORED EDGE FOR CONCRETE - 073B00081N	55.50	LF		\$	
1160	03300		ELIMINATE TRANSVERSE JOINT - 073B00081N	60.10	LF		\$	
1170	03304		BRIDGE OVERLAY APPROACH PAVEMENT - 073B00081N	535.00	SQYD		\$	
1180	04933		TEMP SIGNAL 2 PHASE - 073B00081N	2.00	EACH		\$	
1190	06514		PAVE STRIPING-PERM PAINT-4 IN - 073B00081N	300.00	LF		\$	

Report Date 2/16/21

LINE	BID CODE	ALT	DESCRIPTION	QUANTITY	UNIT	UNIT PRIC	FP	AMOUNT
1200	06549		PAVE STRIPING-TEMP REM TAPE-B - 073B00081N	2,000.00	LF		\$	
1210	06550		PAVE STRIPING-TEMP REM TAPE-W - 073B00081N	2,000.00	LF		\$	
1220	06551		PAVE STRIPING-TEMP REM TAPE-Y - 073B00081N	2,000.00	LF		\$	
1230	08150		STEEL REINFORCEMENT - 073B00081N	670.00	LB		\$	
1240	08504		EPOXY SAND SLURRY - 073B00081N	265.00	SQYD		\$	
1250	08526		CONC CLASS M FULL DEPTH PATCH - 073B00081N	3.00	CUYD		\$	
1260	08534		CONCRETE OVERLAY-LATEX - 073B00081N	11.00	CUYD		\$	
1270	08549		BLAST CLEANING - 073B00081N	350.00	SQYD		\$	
1280	08551		MACHINE PREP OF SLAB - 073B00081N	264.00	SQYD		\$	
1290	24094EC		PARTIAL DEPTH PATCHING - 073B00081N	3.00	CUYD		\$	
1300	24692EC		DECK DRAIN RETROFIT - 073B00081N ~ TYPE 1	4.00	EACH		\$	
1310	24692EC		DECK DRAIN RETROFIT - 073B00081N ~ TYPE 2	6.00	EACH		\$	

Section: 0008 - BRIDGES

LINE	BID CODE	ALT	DESCRIPTION	QUANTITY	UNIT	UNIT PRIC	FP	AMOUNT
1320	02562		TEMPORARY SIGNS - 073B00080N	145.00	SQFT		\$	
1330	02650		MAINTAIN & CONTROL TRAFFIC - 073B00080N	1.00	LS		\$	
1340	02653		LANE CLOSURE - 073B00080N	2.00	EACH		\$	
1350	03299		ARMORED EDGE FOR CONCRETE - 073B00080N	48.00	LF		\$	
1360	03300		ELIMINATE TRANSVERSE JOINT - 073B00080N	52.00	LF		\$	
1370	03304		BRIDGE OVERLAY APPROACH PAVEMENT - 073B00080N	535.00	SQYD		\$	
1380	04933		TEMP SIGNAL 2 PHASE - 073B00080N	2.00	EACH		\$	
1390	06514		PAVE STRIPING-PERM PAINT-4 IN - 073B00080N	600.00	LF		\$	
1400	06549		PAVE STRIPING-TEMP REM TAPE-B - 073B00080N	2,000.00	LF		\$	
1410	06550		PAVE STRIPING-TEMP REM TAPE-W - 073B00080N	2,000.00	LF		\$	
1420	06551		PAVE STRIPING-TEMP REM TAPE-Y - 073B00080N	2,000.00	LF		\$	
1430	08150		STEEL REINFORCEMENT - 073B00080N	670.00	LB		\$	
1440	08504		EPOXY SAND SLURRY - 073B00080N	75.00	SQYD		\$	

Report Date 2/16/21

LINE	BID CODE	ALT	DESCRIPTION	QUANTITY	UNIT	UNIT PRIC	FP	AMOUNT
1450	08526		CONC CLASS M FULL DEPTH PATCH - 073B00080N	3.00	CUYD		\$	
1460	08534		CONCRETE OVERLAY-LATEX - 073B00080N	9.30	CUYD		\$	
1470	08549		BLAST CLEANING - 073B00080N	300.00	SQYD		\$	
1480	08551		MACHINE PREP OF SLAB - 073B00080N	224.00	SQYD		\$	
1490	24094EC		PARTIAL DEPTH PATCHING - 073B00080N	3.00	CUYD		\$	
1500	24692EC		DECK DRAIN RETROFIT - 073B00080N ~ TYPE 1	6.00	EACH		\$	

Section: 0009 - DEMOB

LINE	BID CODE	ALT	DESCRIPTION	QUANTITY	UNIT	UNIT PRIC	FP	AMOUNT
1510	02569		DEMOBILIZATION	1.00	LS		\$	